



Classe100 X16E

User and installation manual

bticino



Contents

Quick guide	4
Answer a call	4
Auto-switching on and camera scrolling	6
Call another room or apartment (intercom)	8
General information	10
Warnings and recommendations	10
Warnings and consumer rights	11
Front view	12
Function keys and status LEDs	12
Rear view	14
Installation	15
Dimensional data and recommended installation heights	15
Wall-mounted installation	15
Installation on the tabletop bases 344692 (optional)	17
Configuration	19
Programming of the programmable keys	20
Use from the device	27
Functions	27
Answer a call	27
Call another room or apartment (intercom)	29
PE or cameras direct auto-switching on	31
NETATMO cameras	33
Door lock release	36
Paging	37
Services	38
Inductive loop (only item 344682)	38
Door status	39
Professional Studio (Office)	40
Safe door lock	41
Device adjustments and settings	42
Use of the joystick	42
Wi-Fi adjustments and settings	43
Settings	54
Remote use	57
Association of Classe100 X16E with Home+Security app	57

Quick guide

Answer a call

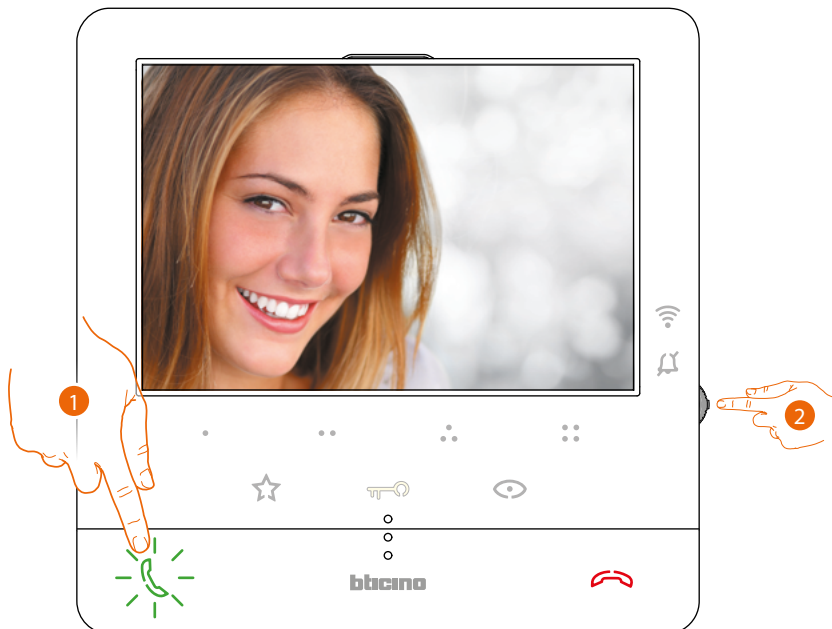

1. Touch to answer the call.
2. If necessary, during the call press the joystick to display the audio/video parameter adjustment icons.



3. Move the joystick up/down to select the type of parameter for which you want to modify the value (see the following table) among:
 - Speaker volume (Parameter that can be adjusted only with active audio);
 - Image brightness;
 - Image contrast;
 - Image colour.

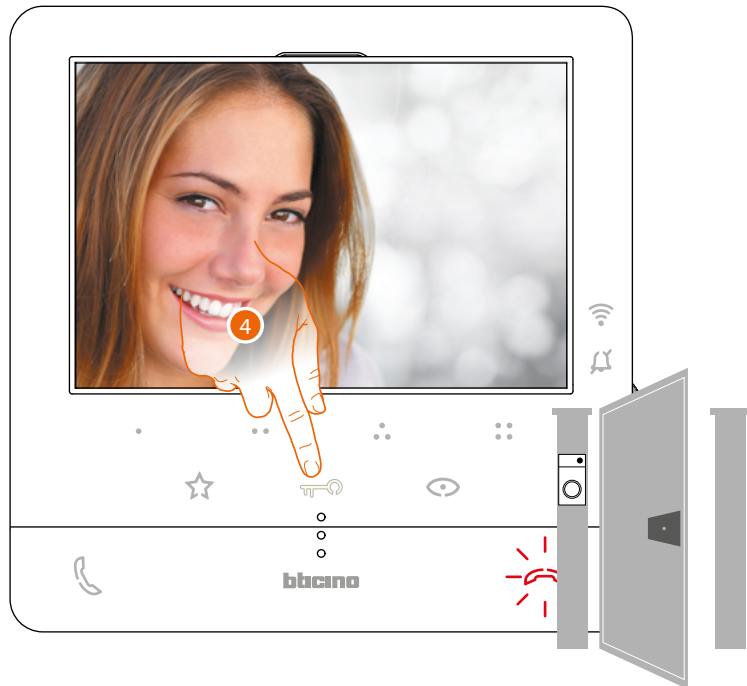

4. Touch to open the main Entrance Panel door lock

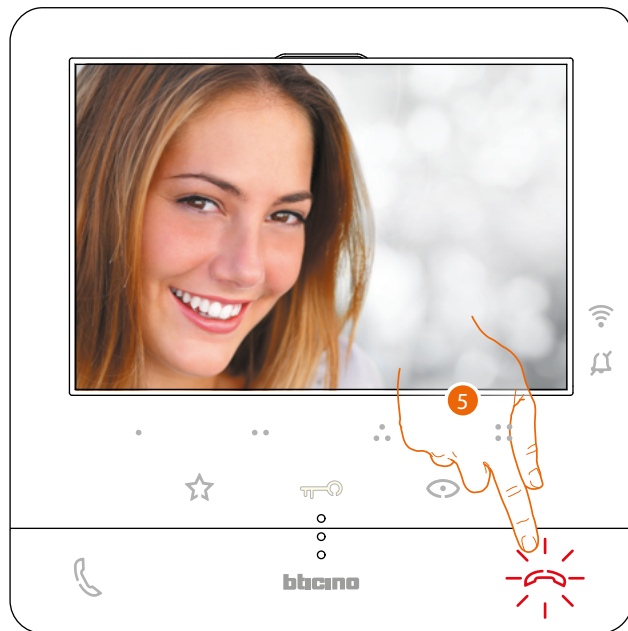

5. Touch to end the call.

Auto-switching on and camera scrolling

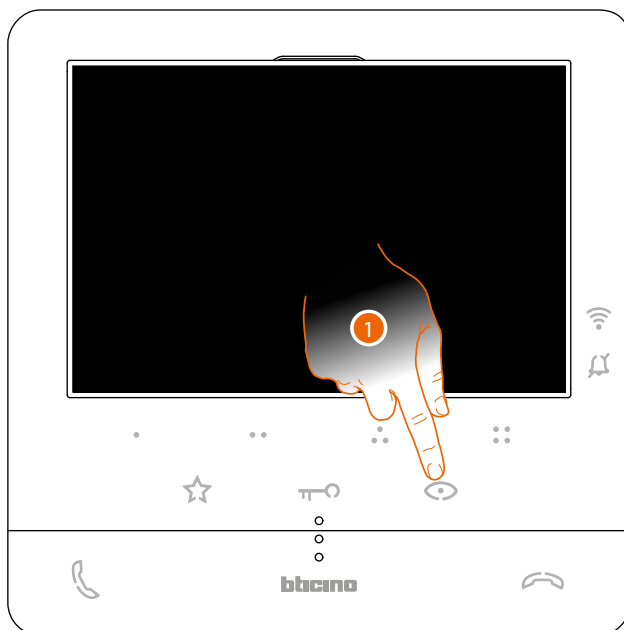

1. Touch to display the Entrance Panels or the cameras in your system.

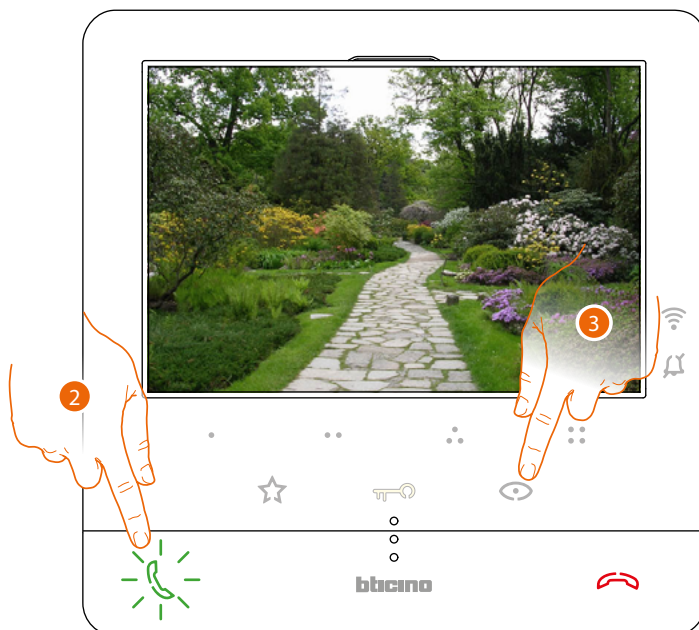

2. If necessary, touch to activate the audio communication
3. Touch to display another Entrance Panel or camera (using the scrolling service). When switching from one camera to the next the key lights up.

Note: switching from one camera to another is also possible without enabling the audio.

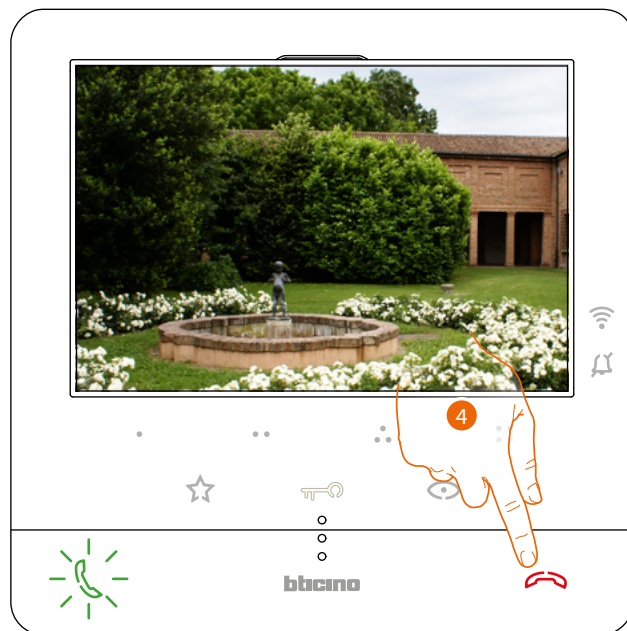

4. Touch to end camera display mode, or wait for the automatic switch off time to elapse.

Call another room or apartment (intercom)

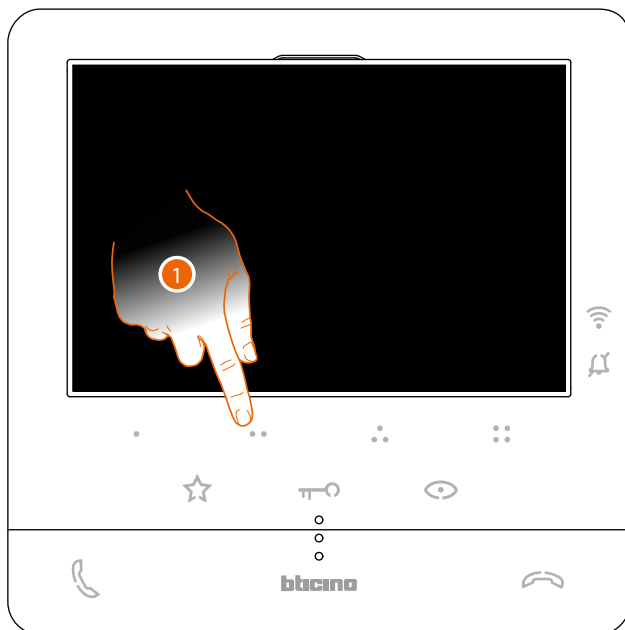

1. For example, touch programmable key ●● to activate the communication with the Internal Unit (e.g. configured as 2)

Note: the programmable key to use for calling a certain Internal Unit is set by the installer (see [Programming of the programmable keys](#)).

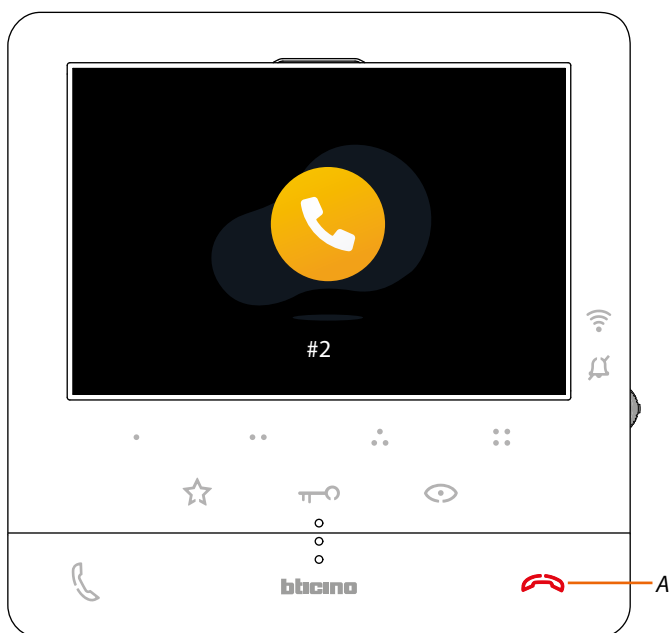

Key (A) lights up to indicate that the call is active.

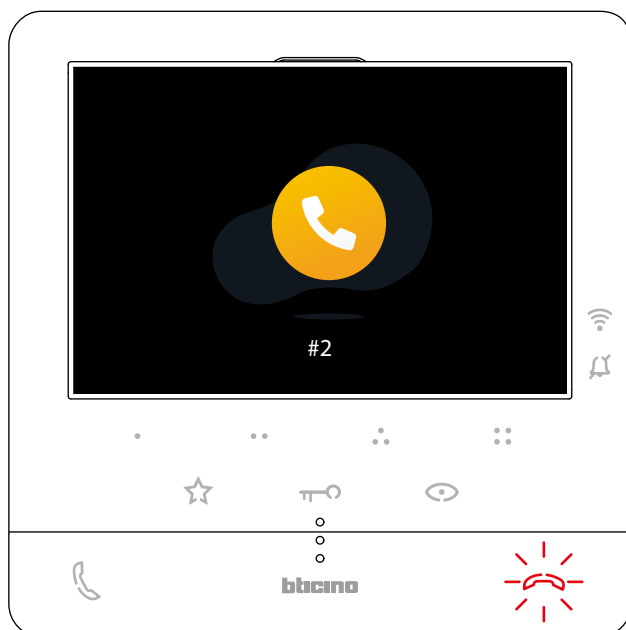

When the Internal Unit answers, the key starts flashing. Touch it to end the call or establish communication with the Internal Unit.

Note: if during the conversation a call is received from the Entrance Panel, the conversation is interrupted in order to answer the Entrance Panel call.

General information

The Classe100 X16E video internal unit must be connected to a Wi-Fi network with the following features:

- IEEE 802.11 b/g/n (2,4 GHz) 13 channels
- Encrypting and authentication methods supported:
- OPEN WPA-PSK networks
- TKIP WPA2-PSK included
- included AES WEP 64 bits (ASCII 5 figure or hexadecimal 10 figure codes)
- WEP 128 bits (ASCII 13 figure or hexadecimal 26 figure codes)
- WPS authentication (supported for WPA2-PSK)

Warnings and recommendations

It is important to read this manual carefully before proceeding with the installation.

The warranty becomes automatically void in case of negligence, improper use, tampering by unauthorised personnel.

The Classe100 X16E video internal unit must only be installed indoors; it must not be exposed to water drops or splashes; it must be used only on BTicino 2 WIRES digital systems.

Note: this device includes the Open Source software. For license and software information, connect your Windows/Linux PC to the device through the mini-USB port.

Note: a domestic Wi-Fi with internet access is needed for the connection between the Classe100 X16E video internal unit and the smartphone.

To use the service, the Customer must acquire the technical equipment which allows access to the Internet, on the basis of an agreement made by the Customer himself with an ISP (Internet Service Provider). BTicino plays no part in this.

The customer must install the Home + Security app on his smartphone so that he can use some services which BTicino supplies as extras to the normal basic functions of the Classe100 X16E.

The services offered by means of the app require being able to interact with Classe100 X16E remotely and through the Internet.

In these cases the integration and good working between Classe100 X16E and app may depend on:

- a) quality of the Wi-Fi signal;
- b) type of access contract to the home internet;
- c) type of data contract on the smartphone;
- d) configuration of the router.

When one of these 4 elements does not conform with the specifications required for product operation, BTicino accepts no responsibility for any faults.

The Home + Security app operation with screen off (background) may be compromised by the applications installed on the smartphone that:

- optimise the use of the battery and the energy saving;
- protect the device (antivirus or similar programs)

The product in fact supports a VoIP streaming system. You must therefore check with your smartphone data network contract that it does not block it.

We would like to inform you that the service provided by BTicino by means of remote use via the app involves the use of data. The cost linked to data usage depends on the type of contract which the customer has with his ISP (Internet Service Provider) and is solely the customer's responsibility.

Warnings and consumer rights



Read carefully before use and keep for future reference



Touching the units with wet hands is forbidden.
Using liquid cleaners or aerosols is forbidden.
Blocking the ventilation openings is forbidden.
Modifying the devices is forbidden.
Removing protective parts from the devices is forbidden.
Exposing the unit to water drops or splashes is forbidden. Installing the units near heat/cold sources or hot/cold air emission points is forbidden.
Installing the units near heat/cold sources is forbidden.
Installing the units near harmful gases and powders is forbidden.
Fastening the units on unsuitable surfaces is forbidden.



Danger of electrical shock



Risk of devices falling because the surface on which they are installed collapses or inappropriate installation
Switch the power supply OFF before any work on the system
Remote operation may cause damage to people or property.



Caution: Installation, configuration, starting-up and maintenance must be performed exclusively by qualified personnel.
Check that the wall installation has been carried out correctly according to the installation instructions.
Check that the unit installation complies with the standards in force.
Connect the power supply wires as indicated.
Use only the items indicated in the technical specifications for any system expansions.

Front view

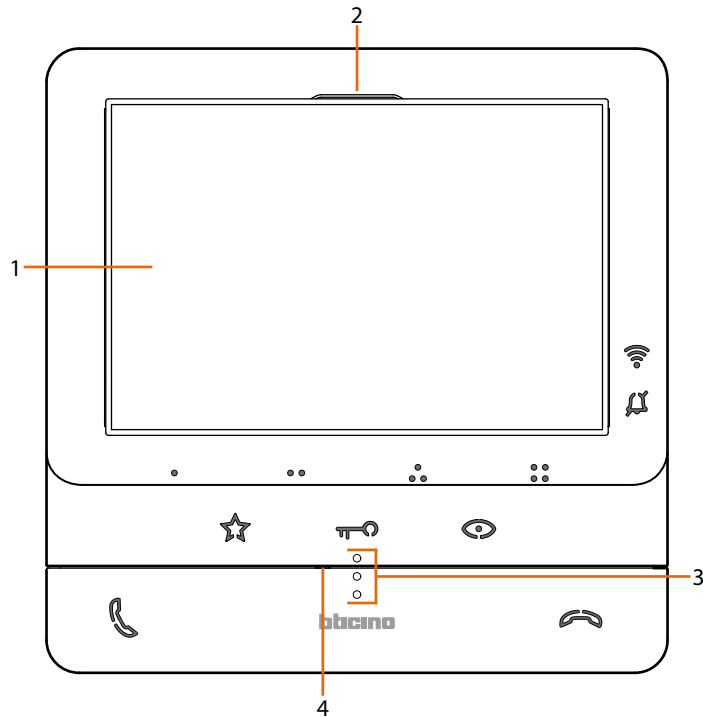

- 1. 5" (16:9) display
- 2. Speaker
- 3. Tactile guides for the blinds
- 4. Microphone

Function keys and status LEDs

Note: when pressed, the keys light up and emit a "beep" (that can be deactivated using the procedure).

Note: the device initialisation procedure can last up to 2 minutes.

Icon	Meaning
Wi-Fi signal notification LED:	
	When it is OFF, the Wi-Fi is disabled or works correctly.
	When it flashes red it indicates that the Wi-Fi is active but not connected to a network.
	When green and on steady, Classe100 X16E is exchanging data with the Home + Security APP (Entrance Panel call/Automatic Switching On/Call Home)
Bell exclusion notification LED:	
	When on red flashing, it means that the call ringtone is disabled,
Programmable touch keys *	
	Use these keys for intercom calls, activate Entrance Panels and Door Locks. The functions that can be completed depend on the configuration set by the installer (see Programming of the programmable keys).
Door lock release touch key *	
	During the connection with an Entrance Panel, use this key to release the door lock of that Entrance Panel, when idle, the same key releases the door lock of the associated Entrance Panel. When on white flashing, it means that the Professional Studio function is active.

Entrance panel/scrolling activation touch key



This key has two functions: It can be used to switch on the camera of the associated Entrance Panel, and to scroll through the connected cameras and/or entrance panels.

Communication disabling key



Use this key to answer a call: when a call is answered, it switches on red; when the call is terminated it switches off.

Staircase light touch key



Use this key to switch the Staircase Light on

Communication enabling key



Use this key to answer a call: when a call is received, the key starts flashing, once the call is answered the light switches off.

** If the LEDs flash white when pressed, the "safe door lock" service is active and the key is deactivated.*

Rear view

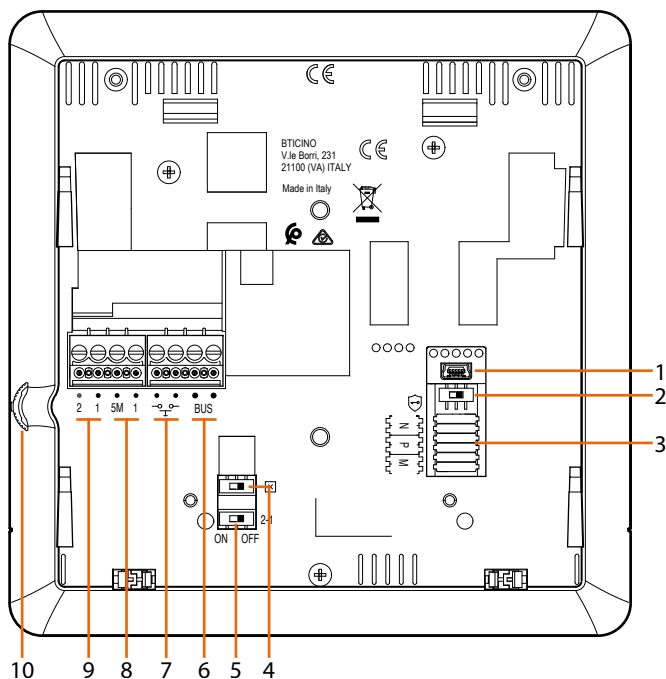

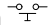
1. Mini USB socket for device Firmware update
2. OFF / ON micro-switch for "safe door lock" service
ON= 
- Note:** to activate the service with device not powered
3. Configurator socket
4. Line termination ON/OFF micro-switch
5. ON / OFF micro switch to enable the additional power supply
6. 2 WIRES SCS/BUS connection clamps
7. Clamps for the connection of an external call to the floor pushbutton 
8. Additional bell connection clamps (5M – 1). The connection must be point - point on the clamps of the additional bells
9. Additional power supply clamps (2– 1)
10. Joystick for adjustments and programming

Installation

! Caution: Installation, configuration, starting-up and maintenance must be performed exclusively by qualified personnel.

Dimensional data and recommended installation heights

Recommended height, unless different regulations are specified.

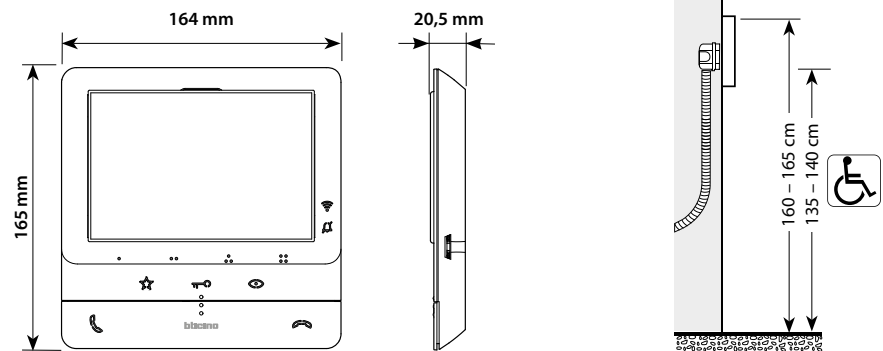

Wall-mounted installation

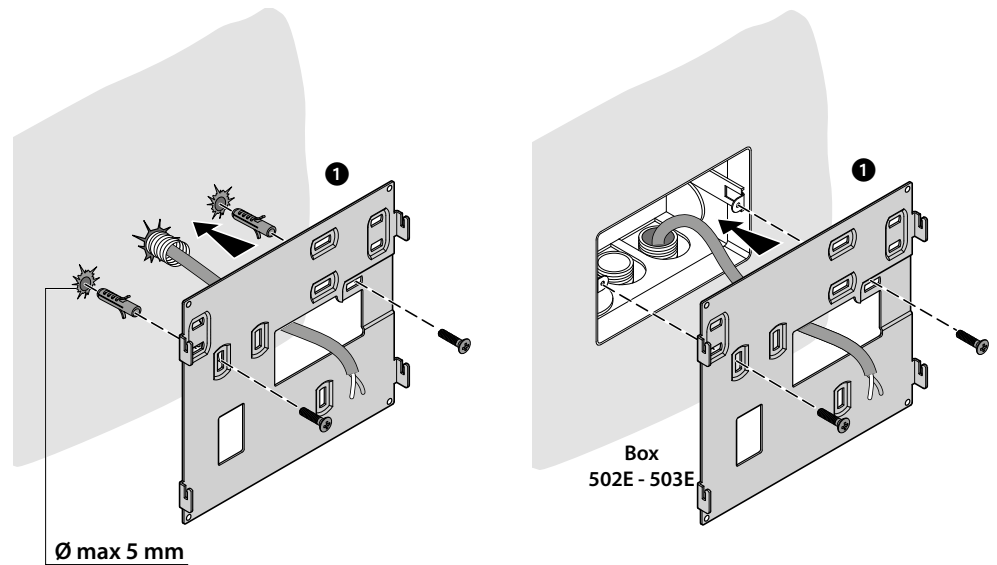

Classe100 X16E

User and installation manual

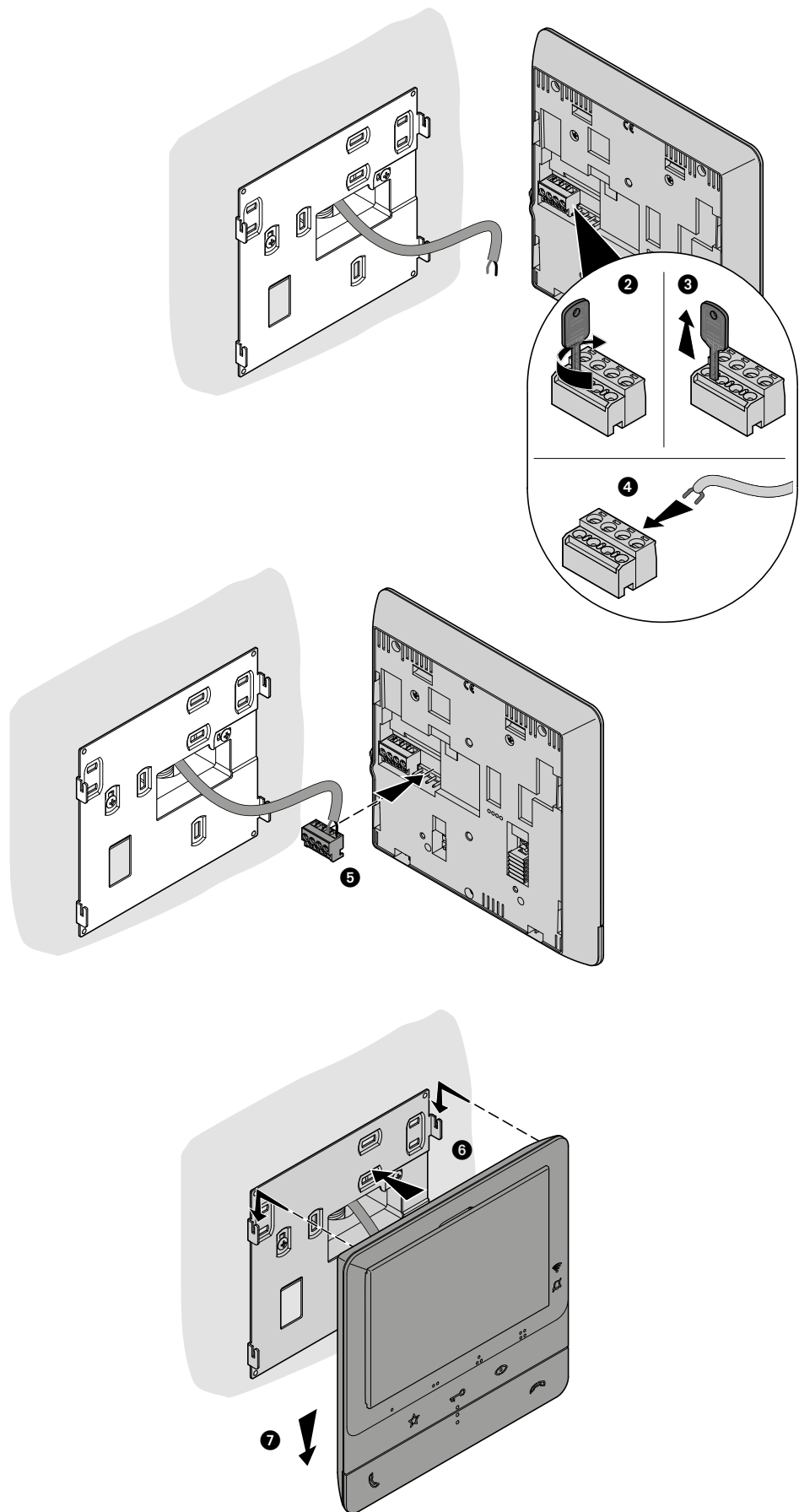

Installation on the tabletop bases 344692 (optional)

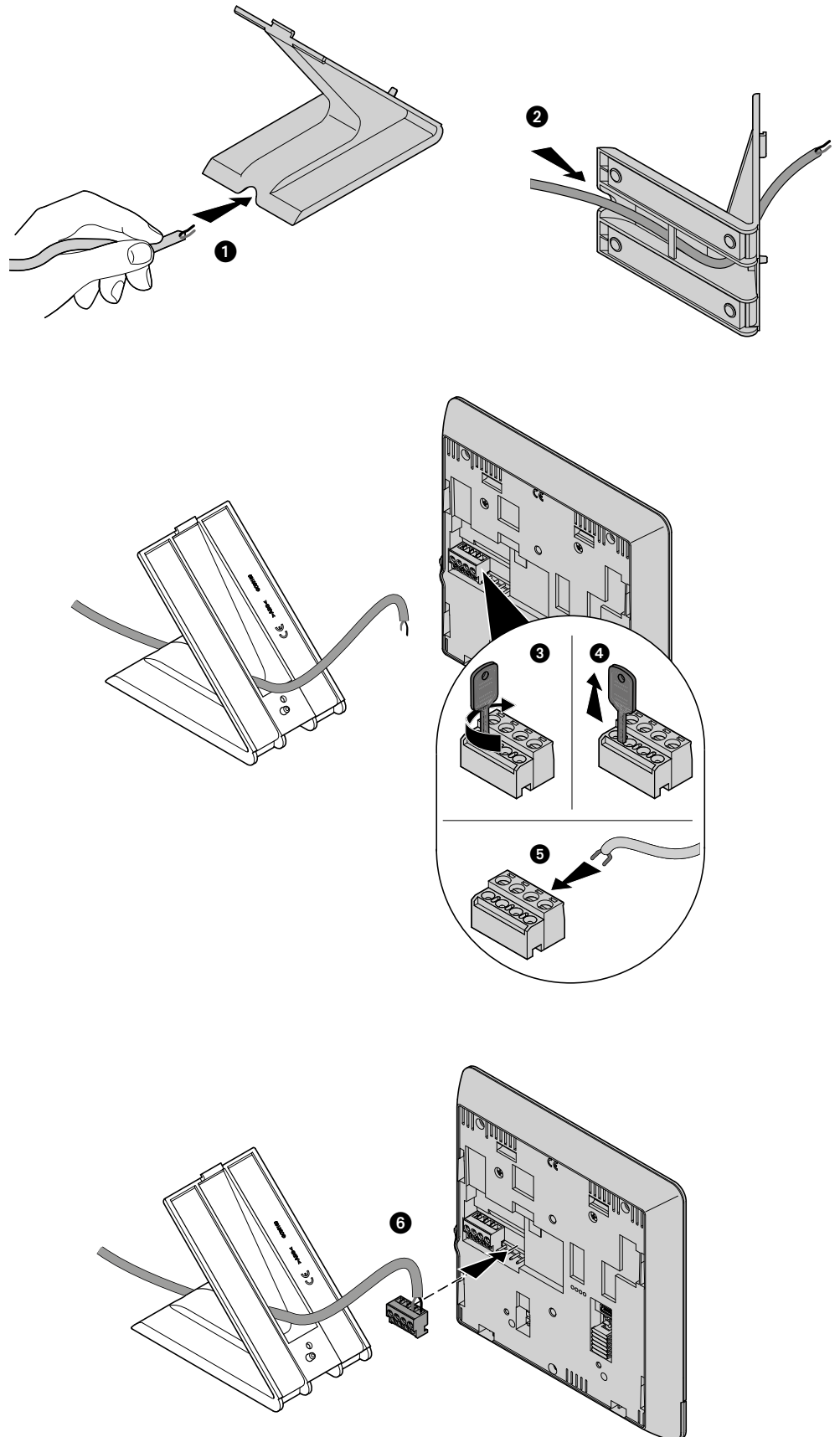

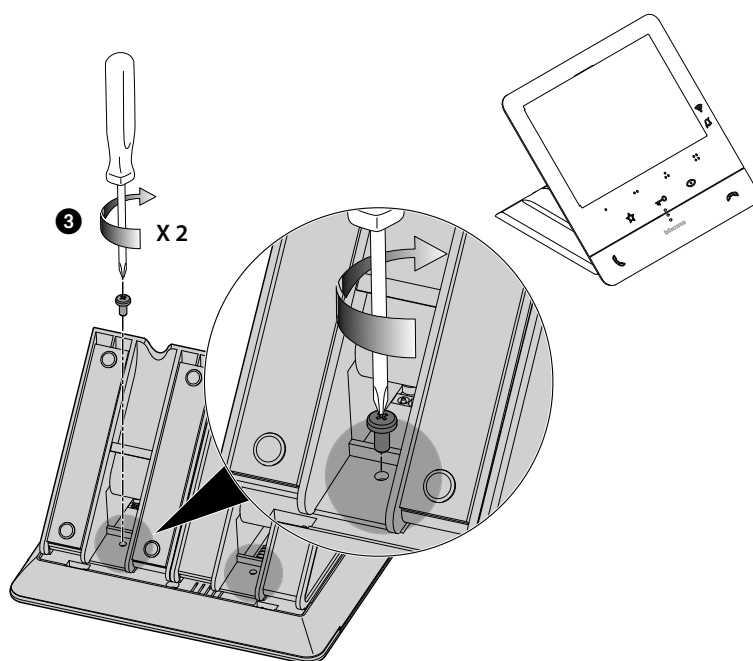
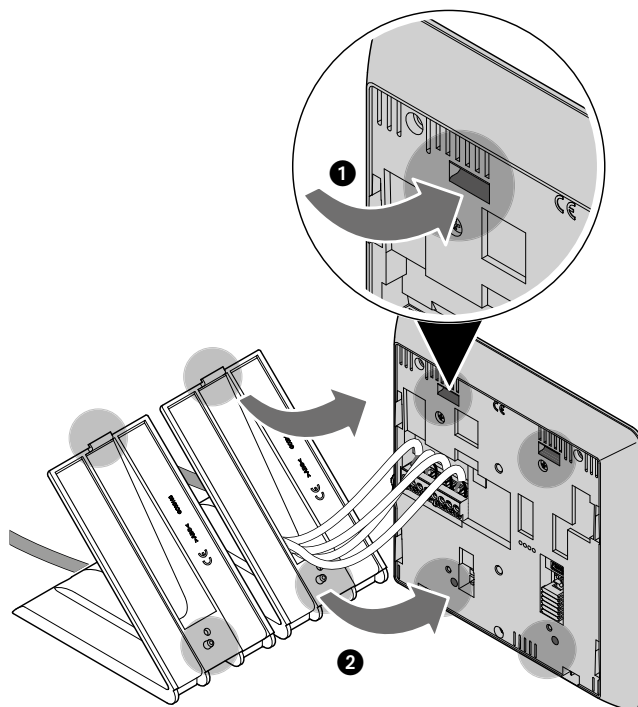

Configuration

The device must be only physically configured.

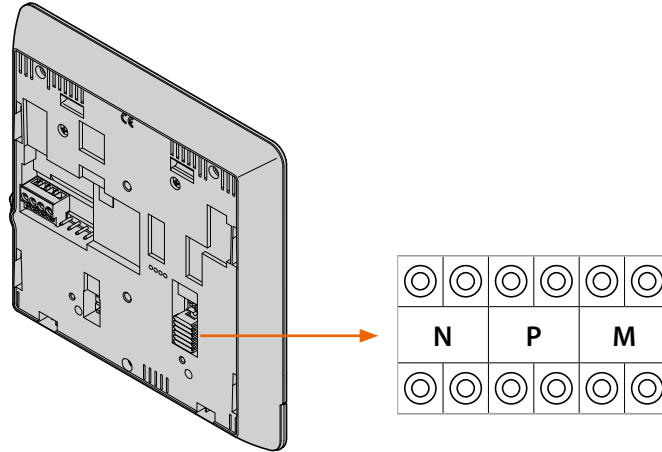

N - Internal Unit number

The configurators connected to the N sockets of the device assign an identification number within the system to each video internal unit. The internal units must be configured in progressive order. Internal units with parallel connection (max 3 are allowed inside apartments without item 346850) must be configured using the same N configurator. In parallel with the main video internal unit, additional internal units, video internal units and/or ringtones may be installed.

P – Entrance Panel association

The configurators connected to the P sockets of the device identify the associated EP, which is the first Entrance Panel that switches itself on when the pushbutton is pressed the first time, as well as which door lock is activated when pressing the door lock pushbutton while the video internal unit is idle.

M – operating mode

The configurators connected to the M sockets of the device assign the operating modes to the 4 programmable keys (●, ●●, ●●●, ●●●●) based on the indications of the [Programming of the programmable keys](#) table.

They can also enable special functions that entail the activation of the professional studio and paging functions, individually or at the same time, in addition to the functions already programmed for the key.

Example

SPECIAL FUNCTIONS				
	Key ●	Internal intercom	Professional Studio (Office)	Paging
CONFIGURATOR M	00	✓	✗	✗
	20	✓	✓	✗
	40	✓	✗	✓
	80	✓	✓	✓

Programming of the programmable keys

Your Classe100 X16E is equipped with keys that perform specific functions depending on the configurator connected to the M socket.

MODE	KEY	SERVICE	NOTES
M = 00	●	Internal intercom It sends the call to all the handsets with the same address	
	● ●	Activation of the EP (configured with P+1) directly without call or activation of the actuator 346210 (configured with P+1 and MOD=9)	
	● ● ●	EP door lock release (configured with P+1), directly without call, or activation of the actuator 346210 (configured with P+1 and MOD=5), or activation of door lock actuators 346230 - 346260 (configured with P+1)	
	● ● ● ●	EP door lock release (configured with P+2), directly without call, or activation of the actuator 346210 (configured with P+2 and MOD=5), or activation of door lock actuators 346230 - 346260 (configured with P+2)	
M = 20		Key functions described above + Professional studio	
M = 40		Key functions described above + Pager	
M = 80		Key functions described above + Professional studio + Pager	
M = 01	●	Internal intercom It sends the call to all the handsets with the same address	
	● ●	Intercom inside the apartment, in systems with apartment interface 346850, or intercom among apartments in systems without apartment interface	
	● ● ●	Activation of the EP (configured with P+1) directly without call or activation of the actuator 346210 (configured with P+1 and MOD=9)	
	● ● ● ●	EP door lock release (configured with P+1), directly without call, or activation of the actuator 346210 (configured with P+1 and MOD=5), or activation of door lock actuators 346230 - 346260 (configured with P+1)	
M = 21		Key functions described above + Professional studio	
M = 41		Key functions described above + Pager	
M = 81		Key functions described above + Professional studio + Pager	

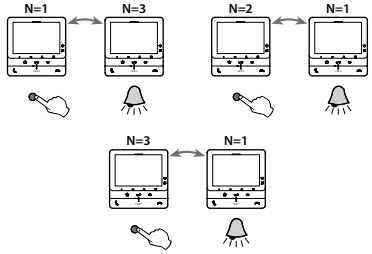
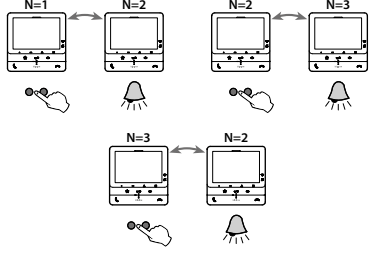
MODE	KEY	SERVICE	NOTES
M = 02	●	<p>Intercom inside the apartment, in systems with apartment interface 346850, or intercom among apartments in systems without apartment interface</p>	
	● ●	<p>Intercom inside the apartment, in systems with apartment interface 346850, or intercom among apartments in systems without apartment interface</p>	
	● ● ●	<p>EP door lock release (configured with P+1), directly without call, or activation of the actuator 346210 (configured with P+1 and MOD=5), or activation of door lock actuators 346230 - 346260 (configured with P+1)</p>	
	● ● ● ●	<p>EP door lock release (configured with P+2), directly without call, or activation of the actuator 346210 (configured with P+2 and MOD=5), or activation of door lock actuators 346230 - 346260 (configured with P+2)</p>	
M = 22		Key functions described above + Professional studio	
M = 42		Key functions described above + Pager	
M = 82		Key functions described above + Professional studio + Pager	

MODE	KEY	SERVICE	NOTES
M = 03	●	Intercom inside the apartment, in systems with apartment interface 346850, or intercom among apartments in systems without apartment interface	
	● ●	Intercom inside the apartment, in systems with apartment interface 346850, or intercom among apartments in systems without apartment interface	
	● ● ●	Intercom inside the apartment, in systems with apartment interface 346850, or intercom among apartments in systems without apartment interface	
	● ● ● ●	Intercom inside the apartment, in systems with apartment interface 346850, or intercom among apartments in systems without apartment interface	
M = 23		Key functions described above + Professional studio	
M = 43		Key functions described above + Pager	
M = 83		Key functions described above + Professional studio + Pager	

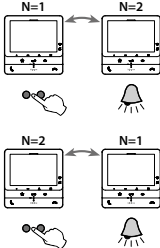
MODE	KEY	SERVICE	NOTES
M = 04	●	Activation of the EP (configured with P+1) directly without call or activation of the actuator 346210 (configured with P+1 and MOD=9)	
	● ●	Intercom inside the apartment, in systems with apartment interface 346850, or intercom among apartments in systems without apartment interface	
	● ● ●	EP door lock release (configured with P+1), directly without call, or activation of the actuator 346210 (configured with P+1 and MOD=5), or activation of door lock actuators 346230 - 346260 (configured with P+1)	
	● ● ● ●	EP door lock release (configured with P+2), directly without call, or activation of the actuator 346210 (configured with P+2 and MOD=5), or activation of door lock actuators 346230 - 346260 (configured with P+2)	
M = 24		Key functions described above + Professional studio	
M = 44		Key functions described above + Pager	
M = 84		Key functions described above + Professional studio + Pager	
M = 05	●	EP door lock release (configured with P+1), directly without call, or activation of the actuator 346210 (configured with P+1 and MOD=5), or activation of door lock actuators 346230 - 346260 (configured with P+1)	
	● ●	EP door lock release (configured with P+2), directly without call, or activation of the actuator 346210 (configured with P+2 and MOD=5), or activation of door lock actuators 346230 - 346260 (configured with P+2)	
	● ● ●	EP door lock release (configured with P+1), directly without call, or activation of the actuator 346210 (configured with P+1 and MOD=5), or activation of door lock actuators 346230 - 346260 (configured with P+1)	
	● ● ● ●	EP door lock release (configured with P+2), directly without call, or activation of the actuator 346210 (configured with P+2 and MOD=5), or activation of door lock actuators 346230 - 346260 (configured with P+2)	
M = 25		Key functions described above + Professional studio	
M = 45		Key functions described above + Pager	
M = 85		Key functions described above + Professional studio + Pager	

MODE	KEY	SERVICE	NOTES
M = 06		<p>“Preset intercom” function with intercommunicating call to the Handset configured with N=1.</p> <ul style="list-style-type: none"> ● From the system handsets it is possible to send an intercom call to the handset configured with N= 1. The indoor unit configured with N=1 can receive intercom calls, but is unable to send them 	
	● ●	<p>Internal intercom It sends the call to all the handsets with the same address</p>	
	● ●	<p>EP door lock release (configured with P+1), directly without call, or activation of the actuator 346210 (configured with P+1 and MOD=5), or activation of door lock actuators 346230 - 346260 (configured with P+1)</p>	
	● ●	<p>EP door lock release (configured with P+2), directly without call, or activation of the actuator 346210 (configured with P+2 and MOD=5), or activation of door lock actuators 346230 - 346260 (configured with P+2)</p>	
M = 26		Key functions described above + Professional studio	
M = 46		Key functions described above + Pager	
M = 86		Key functions described above + Professional studio + Pager	

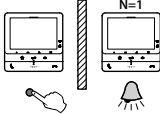
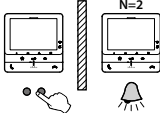
MODE	KEY	SERVICE	NOTES
M = 10		<p>General intercom, it sends the call to all the apartment devices, in systems with apartment interface 346850, or intercom towards all the apartment devices in systems without apartment interface 346850;</p>	
	● ●	<p>Activation of the EP (configured with P+1) directly without call or activation of the actuator 346210 (configured with P+1 and MOD=9)</p>	
	● ●	<p>EP door lock release (configured with P+1), directly without call, or activation of the actuator 346210 (configured with P+1 and MOD=5), or activation of door lock actuators 346230 - 346260 (configured with P+1)</p>	
	● ●	<p>EP door lock release (configured with P+2), directly without call, or activation of the actuator 346210 (configured with P+2 and MOD=5), or activation of door lock actuators 346230 - 346260 (configured with P+2)</p>	
M = 30		Key functions described above + Professional studio	
M = 40		Key functions described above + Pager	
M = 50		Key functions described above + Professional studio + Pager	
M = 12	●	<p>Intercom among apartments X in systems with apartment interface 346850</p>	
	● ●	<p>Intercom among apartments in systems with apartment interface 346850</p>	
	● ●	<p>EP door lock release (configured with P+1), directly without call, or activation of the actuator 346210 (configured with P+1 and MOD=5), or activation of door lock actuators 346230 - 346260 (configured with P+1)</p>	
	● ●	<p>EP door lock release (configured with P+2), directly without call, or activation of the actuator 346210 (configured with P+2 and MOD=5), or activation of door lock actuators 346230 - 346260 (configured with P+2)</p>	
M = 32		Key functions described above + Professional studio	
M = 52		Key functions described above + Pager	
M = 92		Key functions described above + Professional studio + Pager	

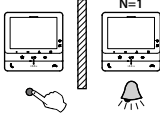
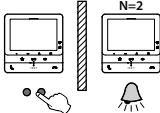
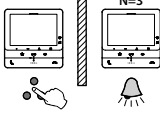
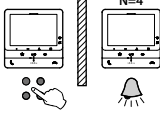
MODE	KEY	SERVICE	NOTES
M = 13	●	Intercom among apartments in systems with apartment interface 346850	
	● ●	Intercom among apartments in systems with apartment interface 346850	
	● ● ●	Intercom among apartments in systems with apartment interface 346850	
	● ● ● ●	Intercom among apartments in systems with apartment interface 346850	
M = 33		Key functions described above + Professional studio	
M = 53		Key functions described above + Pager	
M = 93		Key functions described above + Professional studio + Pager	

Use from the device

Note: the background and icons shown may differ from those on the device.

Functions

[Call another room or apartment \(intercom\)](#)

[NETATMO cameras](#)



[PE or cameras direct auto-switching on](#)

[Door lock release](#)

[Paging](#)

Answer a call

When a call is received, the display shows different information depending on the type of caller:

CALL ORIGIN	DISPLAY
Audio entrance panel	
Video entrance panel	Image taken by the entrance panel
Video door entry unit (intercom)	
Smartphone	

The following procedure illustrates the call from the video EP

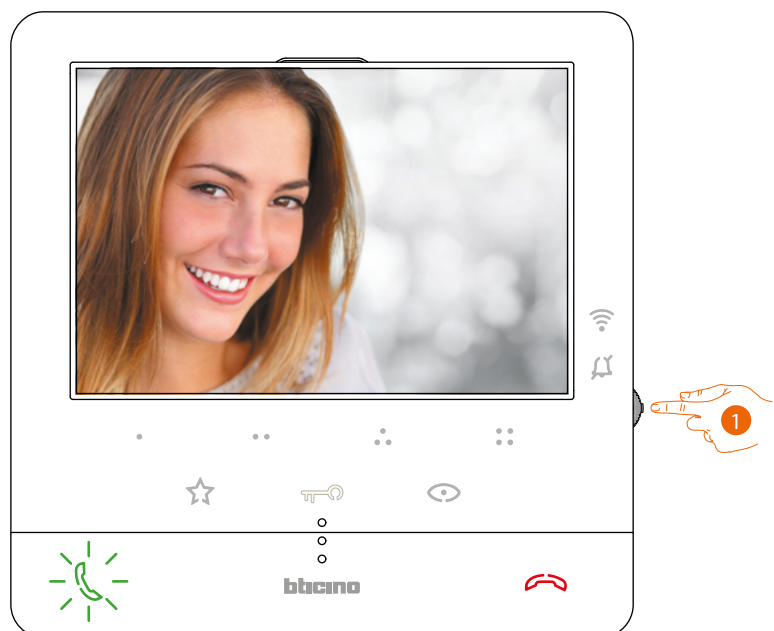

1. If necessary, during the call press the joystick to display the image sound/brightness/contrast/colour adjustment menu (see [Audio/video parameter adjustment](#)).

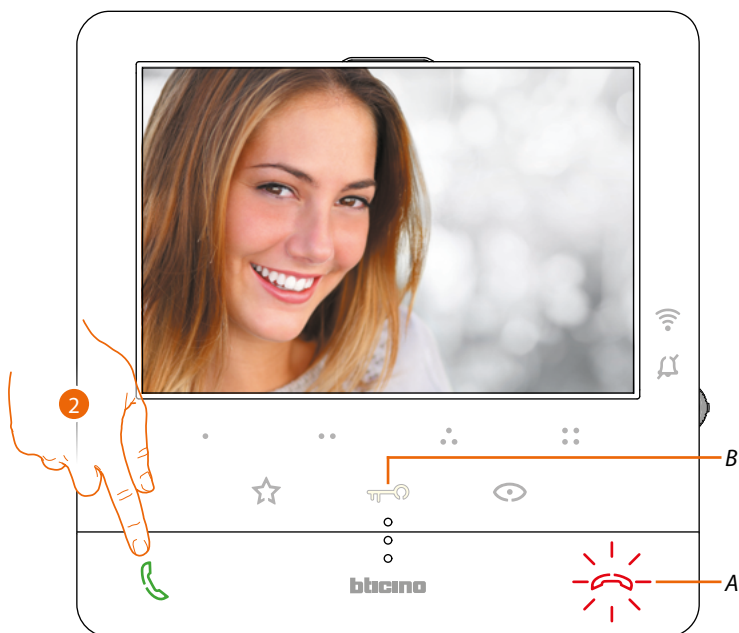

2. Touch to answer the call. The LED switches off. To end the call touch the (A) key, and to open the Entrance Panel door lock touch the (B) key.

Call another room or apartment (intercom)

This section can be used to communicate with other video/audio Internal Units installed in your home, or in other apartments.

The programmable key to use for calling a certain Internal Unit is set by the installer (see [Programming of the programmable keys](#)).

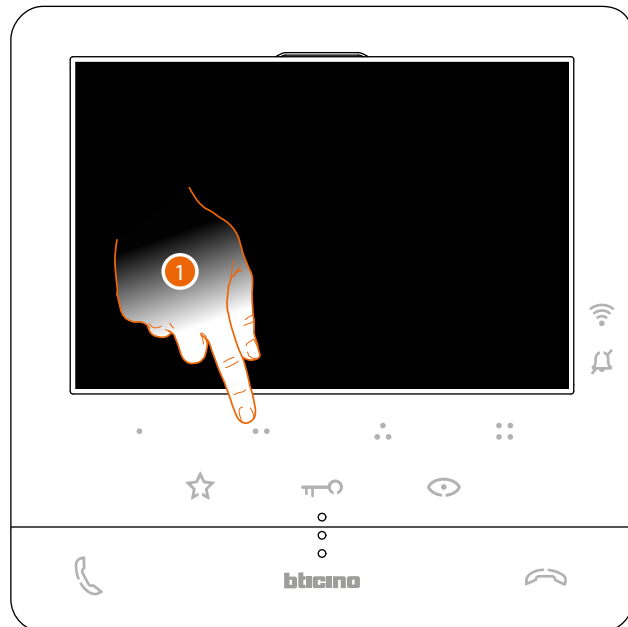

1. For example, touch programmable key ●● to activate the communication with the Internal Unit (e.g. configured as 2)

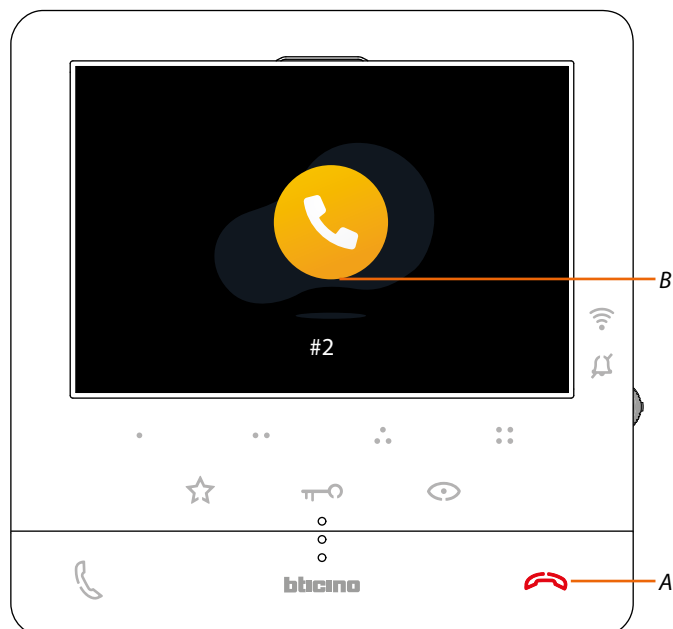

Key (A) lights up to indicate that the call is active.
The display shows the ID of the Internal Unit called (B).

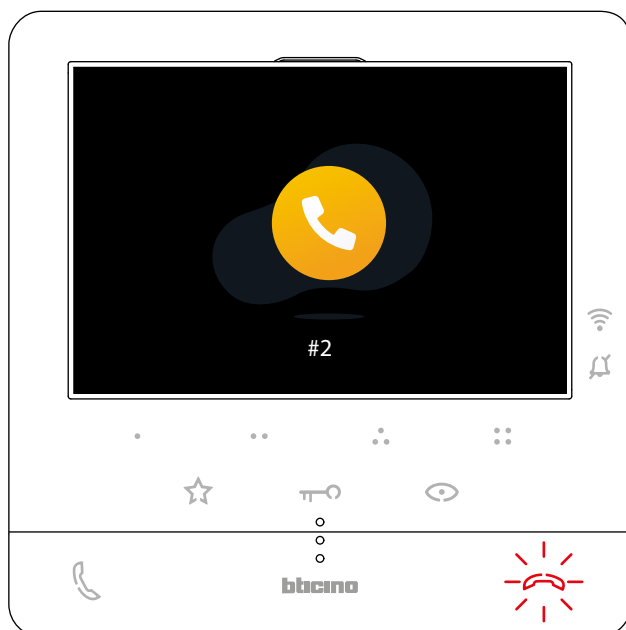

When the Internal Unit answers, the key starts to flash; communicate with the Internal Unit, or touch to close the call.

Note: if during the conversation a call is received from the Entrance Panel, the conversation is interrupted in order to answer the Entrance Panel call.

PE or cameras direct auto-switching on

Using the automatic switch on key it is possible to display the main Entrance Panel camera and, if installed, scroll through other cameras/Entrance Panels.

Using the programmable keys it is also possible to directly display a camera or Entrance Panel. The programmable key to use for calling a certain Entrance Panel is set by the installer (see [Programming of the programmable keys](#)).

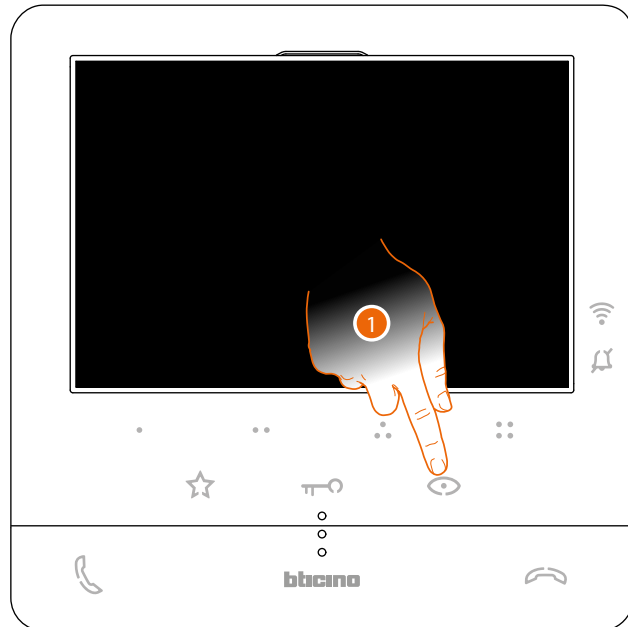

1. Touch to display the Entrance Panels or the cameras in your system.



2. If necessary, during the call press the joystick to display the image sound/brightness/contrast/colour adjustment menu (see [Audio/video parameter adjustment](#))

The (A) key flashes; if necessary, touch this key to enable audio communication.

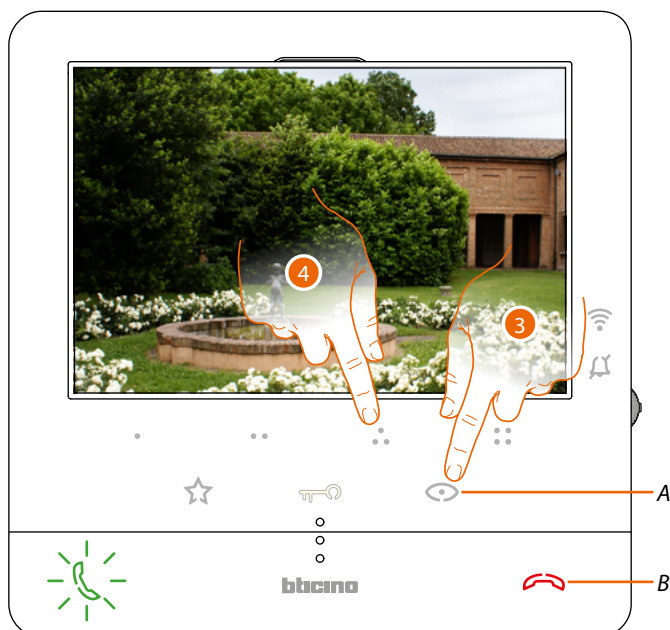

3. Touch to display another Entrance Panel or camera (using the scrolling service).
When switching from one camera to the next, the (A) key lights up.
To end camera display mode wait for the switching off time to elapse or press the (B) key

Note: switching from one camera to another is also possible without enabling the audio.

Note: NETATMO cameras are not included in the cycling function, and therefore will not be displayed. To display a Netatmo camera refer to the [Netatmo Cameras](#) section

4. To display a specific Entrance Panel, touch (for example) programmable key ☉



NETATMO cameras

If your home includes NETATMO cameras, after associating them to the Home + Security App you will be able to use them for video control directly from your Classe100 X16E with Netatmo.

If your NETATMO account is associated to several homes, each with one or more cameras, the full home list will be displayed.

You will therefore be able to see images of your seaside home from your Classe100 X16E installed in your main home

Note: this page appears only if the display of the NETATMO cameras has been activated in the Home+Security app.

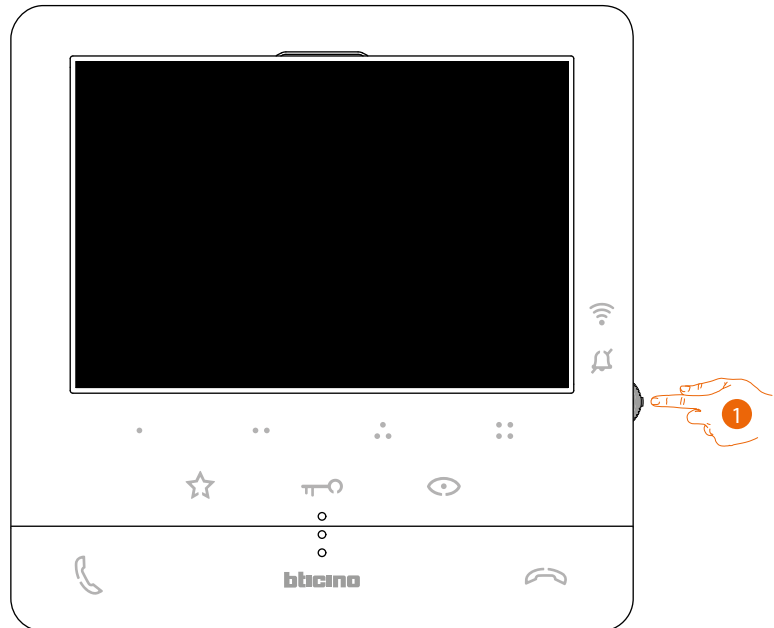

1. From stand-by press the joystick to activate the display.

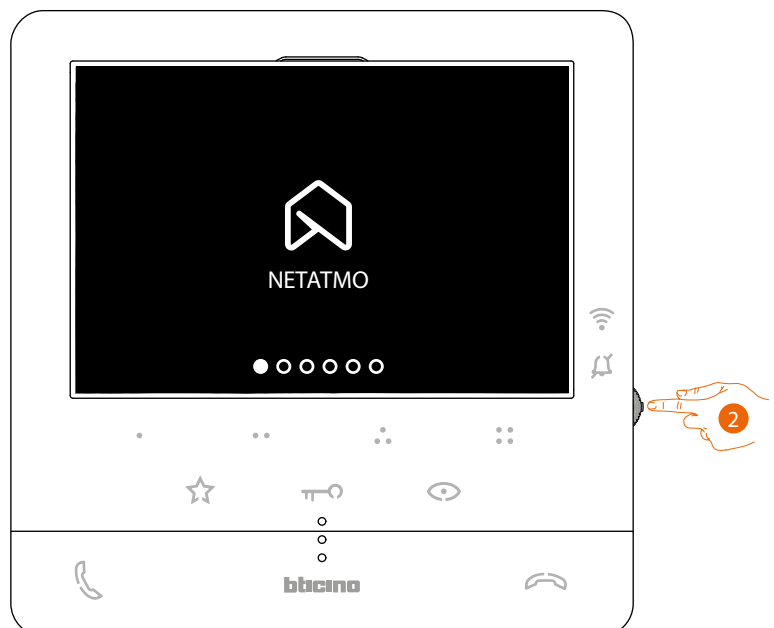

2. Press to display the Netatmo cameras in your home.

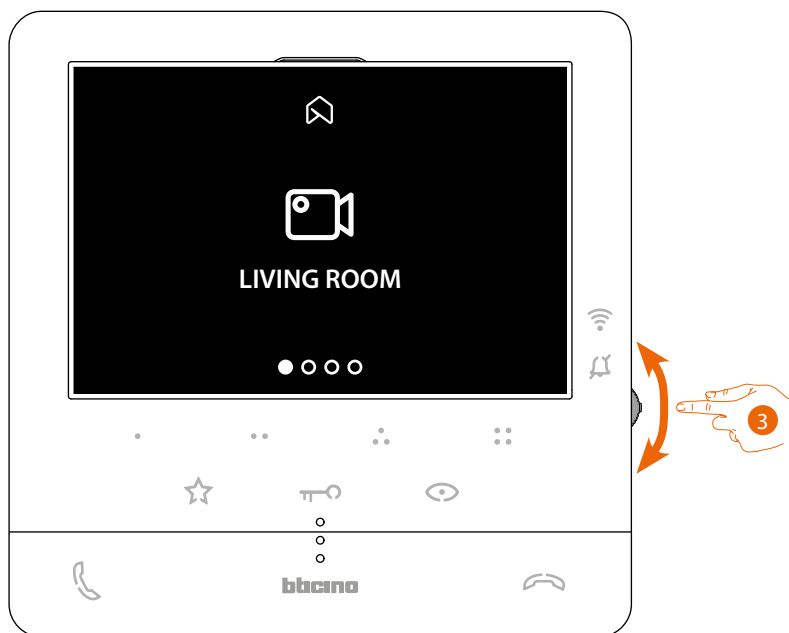

3. Move the joystick up/down to select the camera that you want to display.



4. Touch to activate the desired camera, (the image is displayed for three minutes).

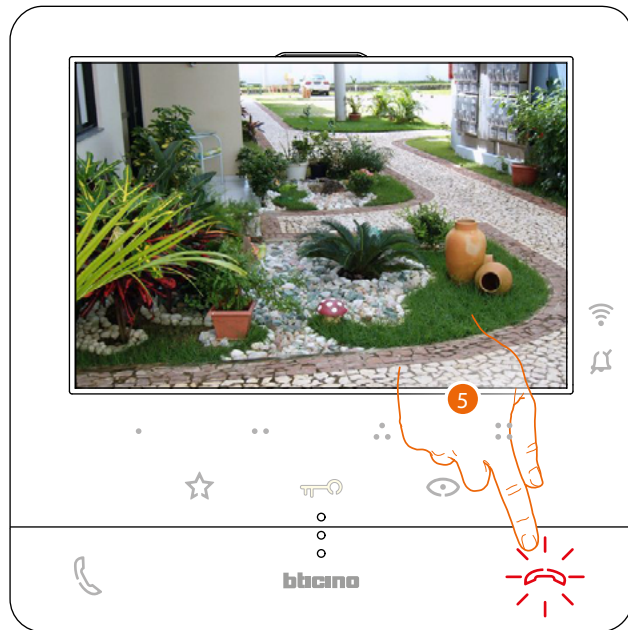

5. Touch to end.

Door lock release

It is possible to open the main Entrance Panel door lock, using the door lock key. Using the programmable keys, it is also possible to open the system door locks. The programmable key to use for opening a certain door lock is set during the configuration by the installer (see [Programming of the programmable keys](#)).

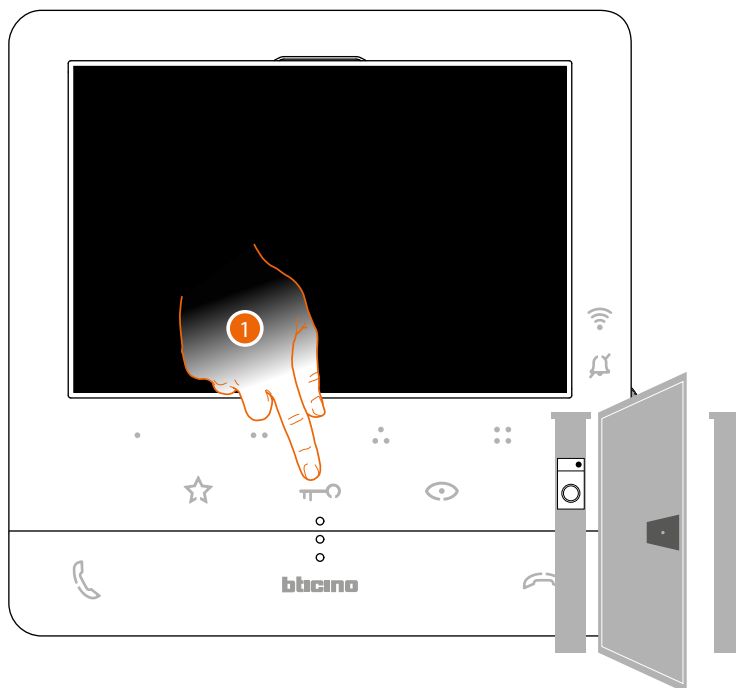

1. Touch to open the main Entrance Panel door lock.

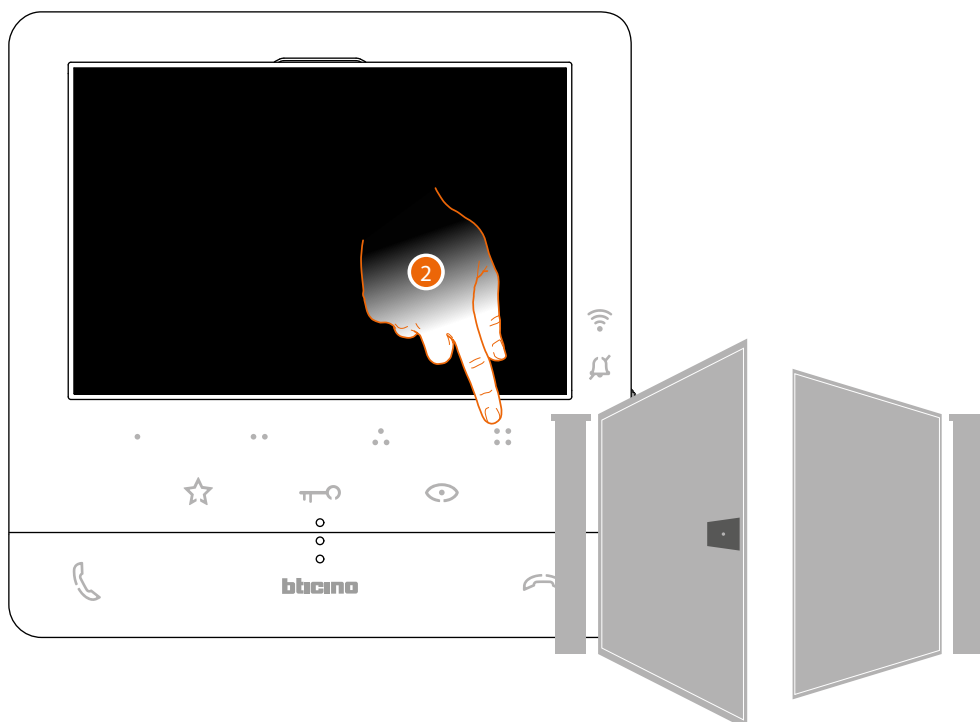

2. To open a specific door lock, touch (for example) programmable key .

Paging

This function can be used to send voice messages using the microphone of the Classe100 X16E through the speakers of the sound system.

This function is enabled during the configuration by the installer (see [Programming of the programmable keys](#))

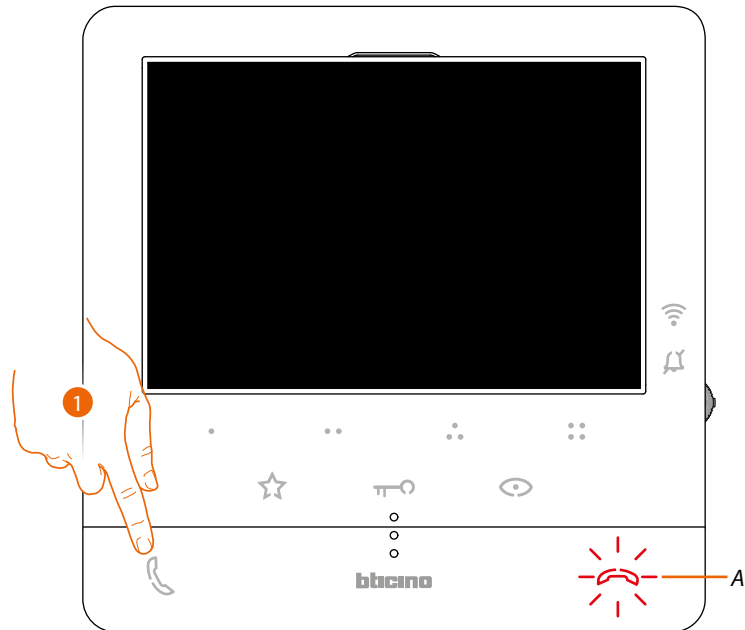

1. Touch to open the communication, the key (A) lights up to indicate that the call is active

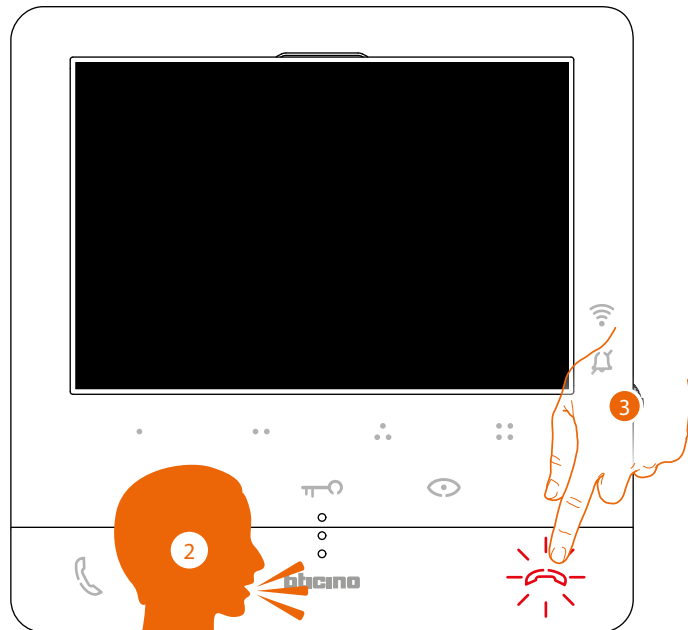

2. Play the message.
3. Touch to end the call.

Services

With preset systems it is possible to also enjoy a range of services, such as:

[Inductive loop \(only item 344682\)](#)

[Door status](#)

[Professional Studio \(Office\)](#)

[Safe door lock](#)

Inductive loop (only item 344682)

The INDUCTIVE LOOP service enables the device to be used by people wearing hearing aids with (T) selector.

Switch the acoustic device to the T position. To ensure correct magnetic coupling between the handset and the acoustic device, we recommend a position in front of the device, at a distance of 25-35 cm.

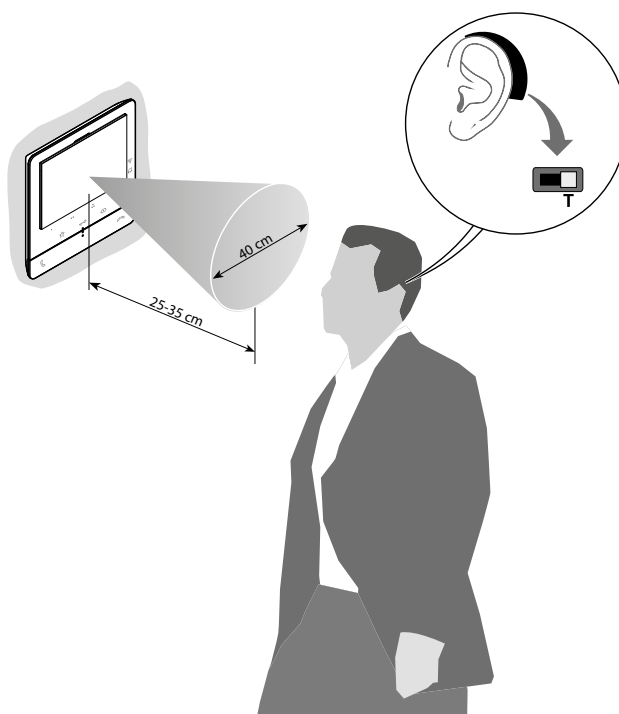

Note: the presence of metal and background noise generated by electric/electronic devices (e.g. computer) may compromise the performance and the quality of the coupling device.

Door status

This service indicates through the door lock LED if the entrance door is open or closed. This service is enabled during the configuration by the installer (see [Programming of the programmable keys](#)).

Note: the service is active only if required by the system - accessory devices are required.

Note: It cannot be activated together with the Professional Studio (Office) service.

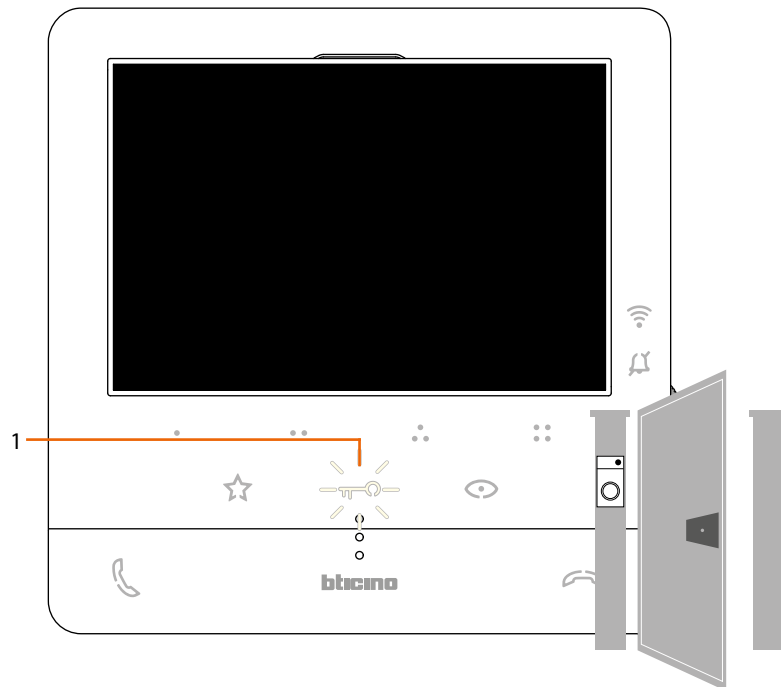

1. If the LED flashes, the entrance door is open.

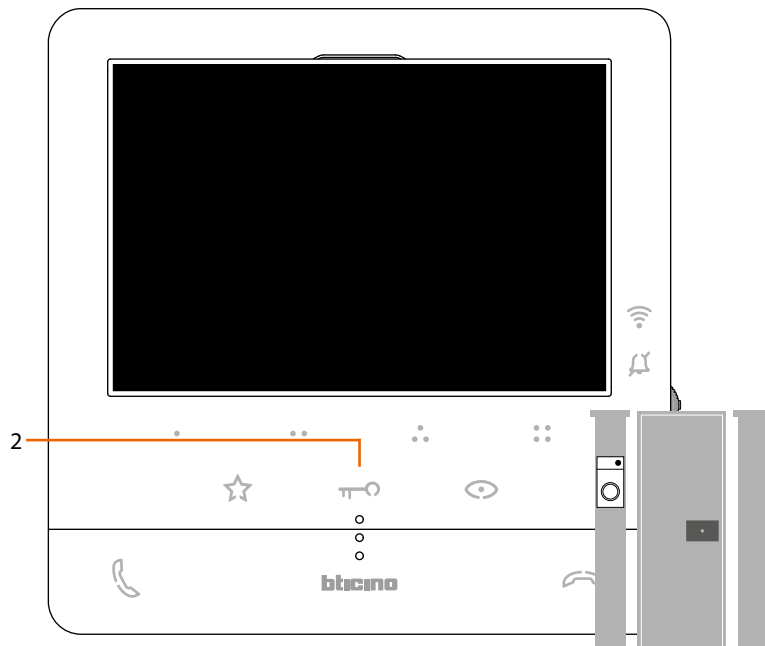

2. If the LED is off, the entrance door is closed.

Professional Studio (Office)

When a call is received from the Entrance Panel, this service automatically opens the associated door lock without the need for pressing the door lock control key.

This service can be enabled during the configuration by the installer (see [Programming of the programmable keys](#)) and activated using the specific menu (see [enable/disable Professional Studio](#)).

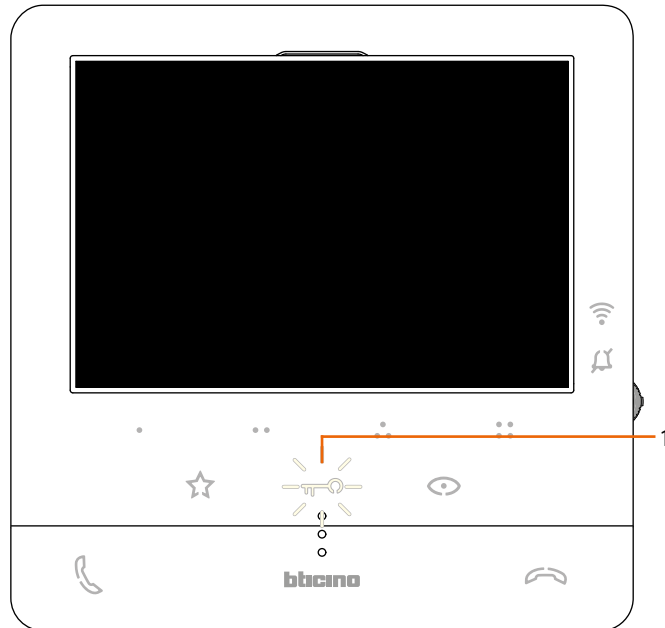

1. If this service is active, the Door Lock LED flashes.

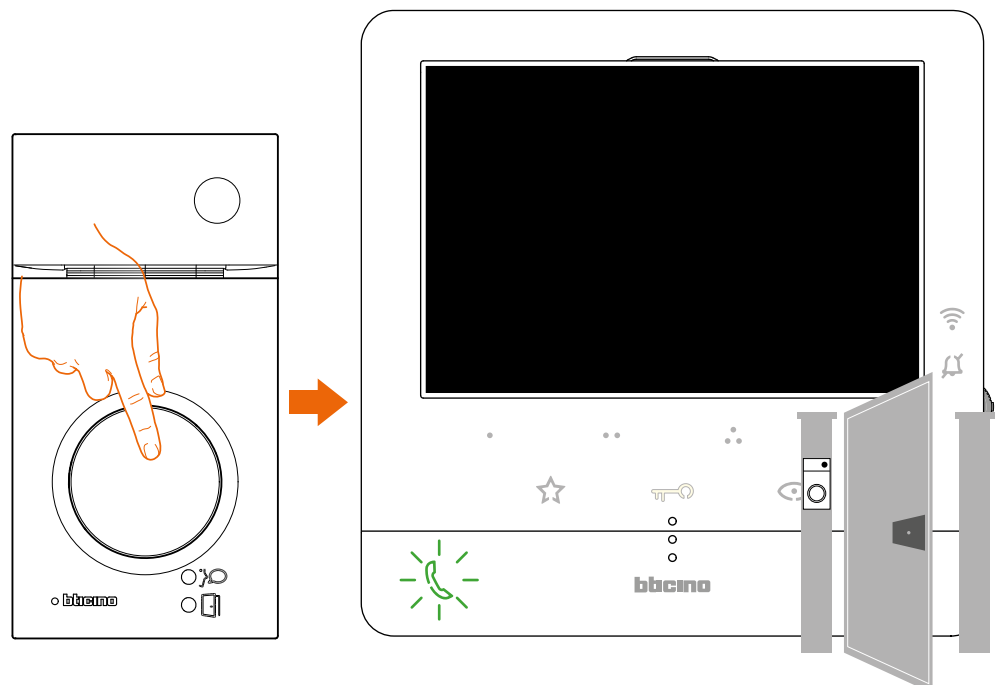

When a call is received from the Entrance Panel, the door lock is opened automatically.

Safe door lock

When active, this service prevents the opening of the Entrance Panel door lock unless communication with the same is active.

Therefore, the opening of the door lock is only permitted when Entrance Panel and Internal Unit are in voice communication.

This service is enabled during the configuration by the installer (see [rear view](#)).

Note: the service cannot be activated together with the Professional Studio (Office) service

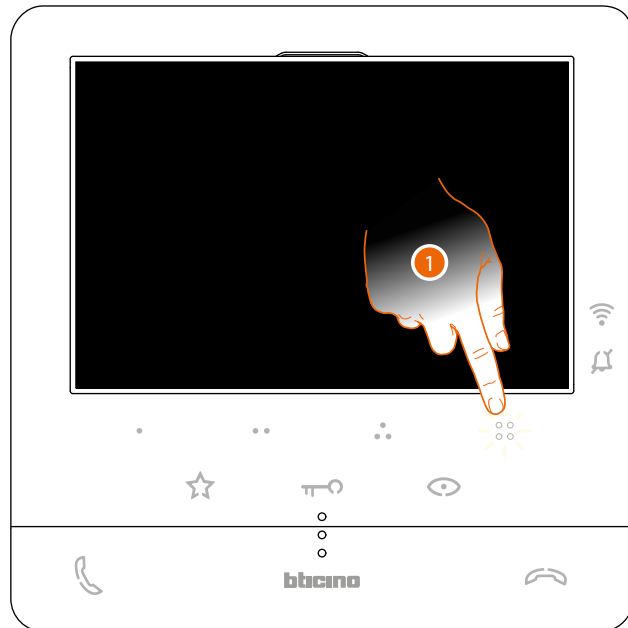

When this service is active, the door lock key or one of the programmable keys that activate the door lock are disabled.

1. If one of these controls is pressed, the corresponding LED flashes, but the command is not executed.

Device adjustments and settings

Using the joystick it is possible to perform adjustments (Adjustments and/or Parameter Adjustment menu during Audio/Video connection) and settings (Settings menu)

Use of the joystick

You must use the joystick on the side of the device to navigate on the menu and select the settings.

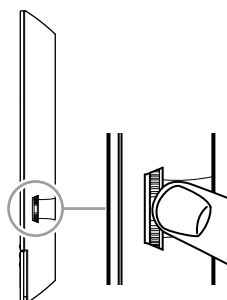

SYMBOL	ACTIONS TO BE PERFORMED	SERVICE
	Press	Confirm/access the Adjustments mode
	Press and hold down for more than 5 sec	Access the Settings mode
	Move the joystick up (when released, it returns to central position)	Previous page/increase level
	Move the joystick down (when released, it returns to central position)	Next page/decrease level

Wi-Fi adjustments and settings

Wi-Fi adjustments and settings menu

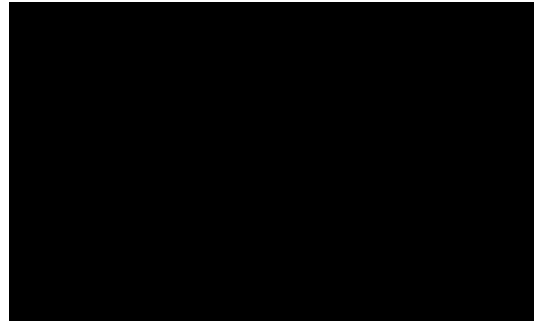

From stand-by press the joystick to activate the display



Move the joystick up/down to select the page among:

You can download the Home + Security App from the Stores.

The page disappears after the first association with the App:



Note: the image shows the device with all its functions enabled. The background and icons shown may differ from those on the device.

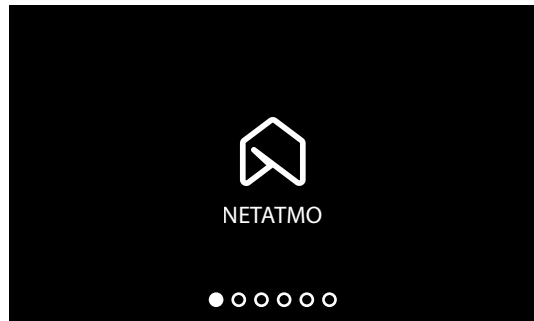

Display [the NETATMO cameras](#)

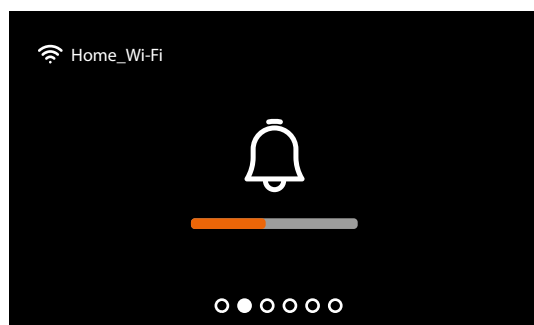

[Adjust the ringtone volume.](#)

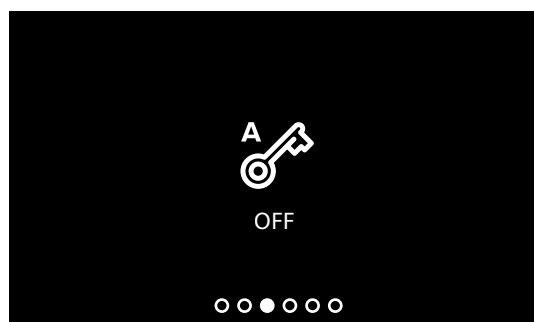

[Activate/deactivate the Professional studio-Office function.](#)

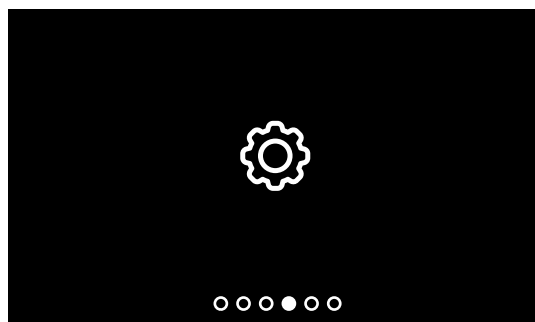

Wi-Fi settings page, where it is possible to enable/disable/reset the Wi-Fi, perform the first association to the app and reset the device.

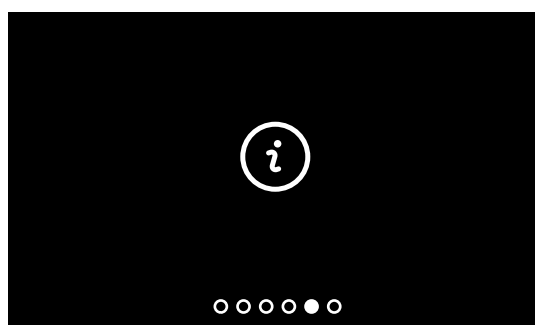

Device info.

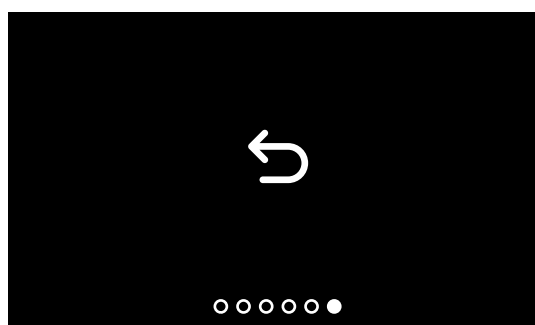

Exit the menu.

Ringtone volume adjustment

From stand-by press the joystick to activate the display and select the corresponding page.

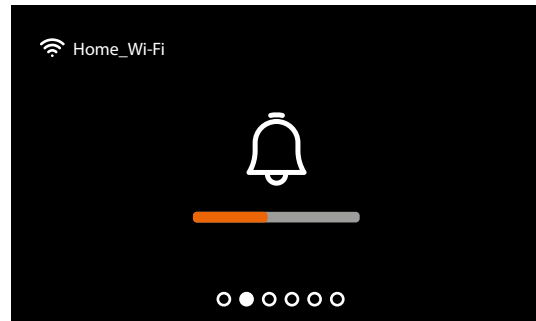

- 1 Press the joystick to adjust the volume.
The ringtone is played at the set volume level.

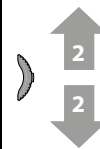
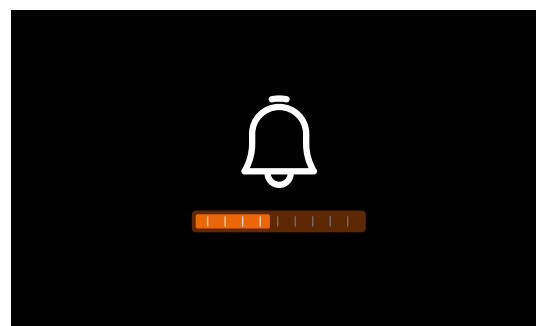

- 2 Move the joystick up/down to select the volume level (1 – 8).

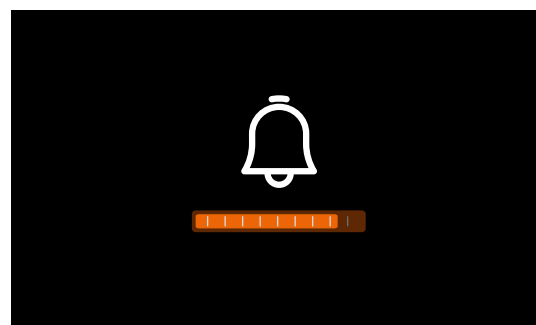

- 3 Press the joystick to confirm the setting or wait for the timeout.

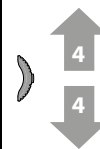
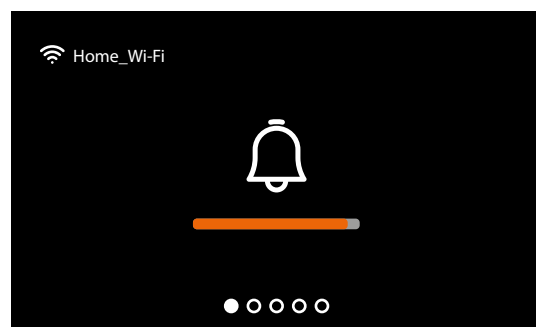

- 4 Move the joystick up/down to select another setting or the last page to exit.

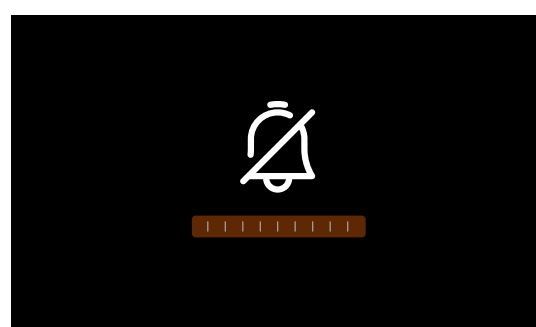

The minimum level corresponds to the exclusion of the ringtone. The corresponding LED flashes red.

Activate/deactivate the professional studio-office function

When a call is received from the entrance panel, this function automatically activates the associated door lock without the need for pressing the door lock control key.

To enable this function, Classe100 X16E must be configured as shown in the [Programming of the programmable keys](#).

Moreover, the function must be enabled as follows:

From stand-by press the joystick to activate the display and select the corresponding page

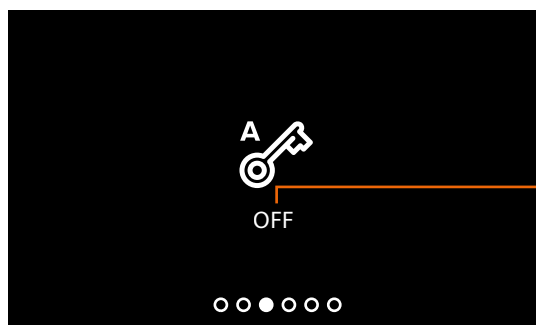

- A Function status notification (ON = enabled, OFF = disabled).
- 1 Press the joystick to change mode.

Note: it cannot be activated together with the Safe Door Lock and the Door Status function.

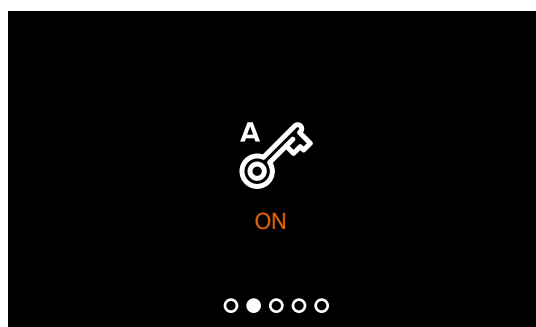

- 2 Move the joystick up/down to select another setting or the last page to exit.

WI-FI settings

From stand-by press the joystick to activate the display and select the corresponding page.

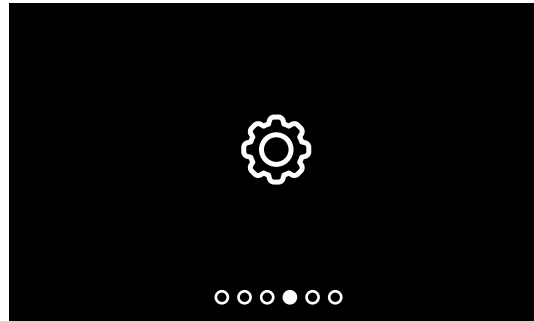

Press the joystick to select the page of interest.

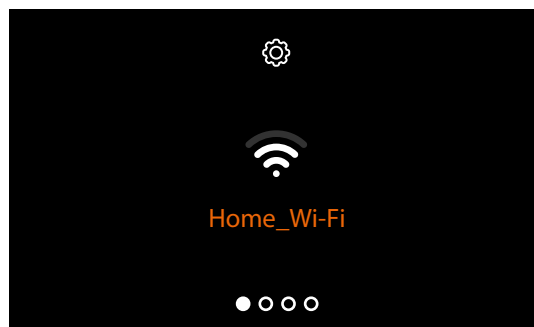

[Enable/disable the Wi-Fi Network](#)



Note: to connect the device to the Wi-Fi network and to the app, you must first associate the Classe100 X16E to the Home + Security app.

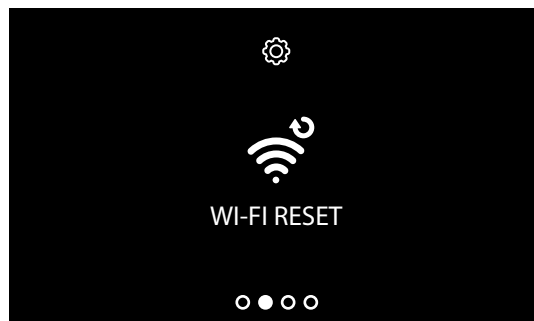

[Reset the Wi-Fi network](#)

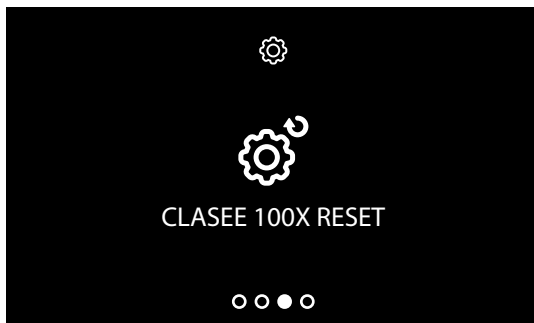

Device reset

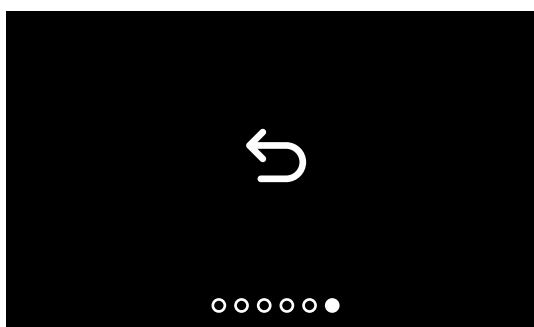

Exit the menu.

Enable/disable the Wi-Fi Network

In this page you can display the Wi-Fi network to which the device is connected and if necessary disable the connection.

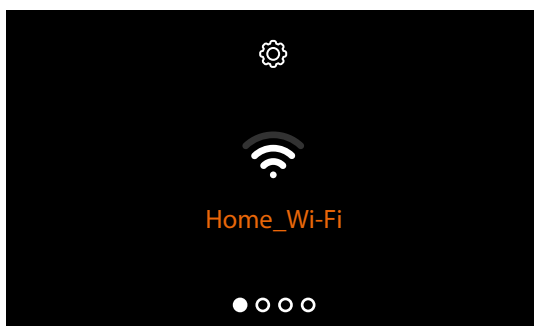

- A Wi-Fi network name to which the device is connected;
- 1. press the joystick to disable the Wi-Fi network.

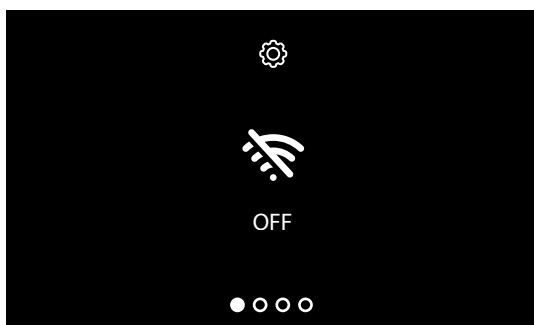

Now the Wi-Fi network is no longer active, but the device is still authenticated to it.

Note: to disconnect the Wi-Fi network from the device, the device must be **reset** following the appropriate procedure.

Reset the Wi-Fi network

In this section it is possible to change the Wi-Fi network to which the device is connected, or the network password.

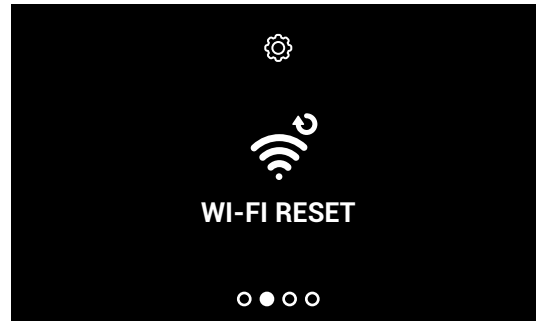

1. Press the joystick to reset the Wi-Fi network.

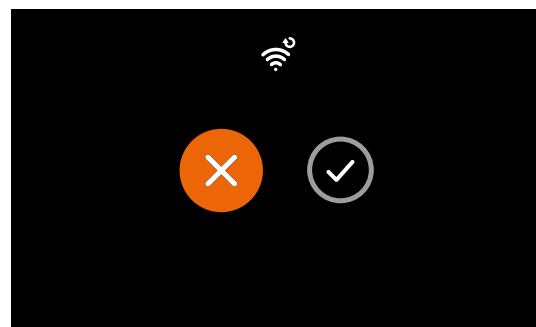

2. Move the joystick down to select the confirmation icon.

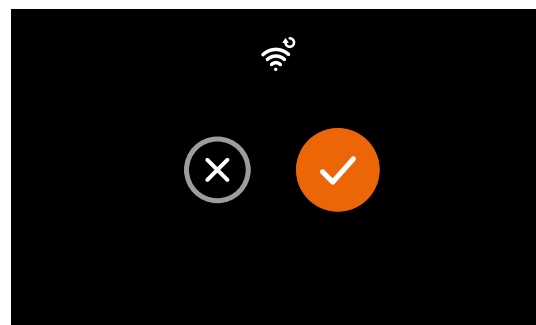

3. Press the joystick to confirm.



Now the device is no longer connected to the Wi-Fi network.
To reconnect the device to the same network or to a new one, you must complete the guided procedure from the Home + Security app in the [Settings/ Set the video internal unit Wi-Fi](#).

Note: if the procedure is not completed, after a few seconds the connection is restored.

Device reset

This page can be used to reset the device.

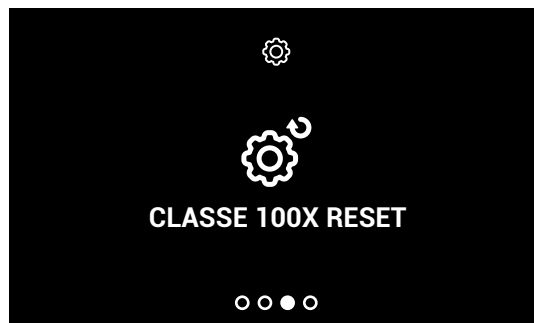

1. Press the joystick to reset the device.

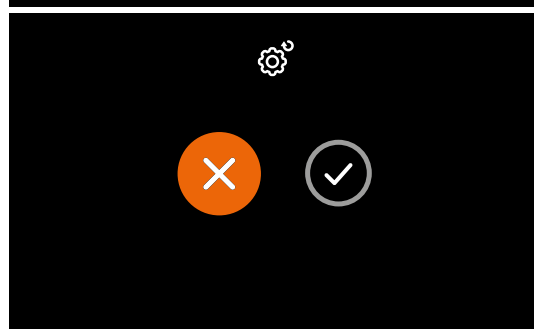

2. Move the joystick down to select the confirmation icon.

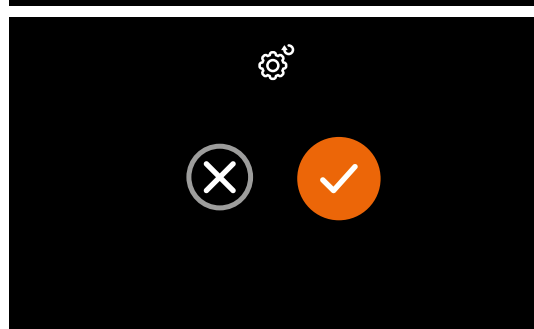

3. Press the joystick to confirm.



Note: all the data concerning associated accounts and the Wi-Fi connection will be deleted.

Device info

From stand-by press the joystick to activate the display and select the corresponding page.

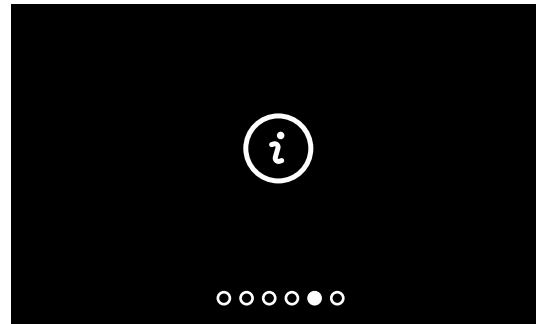

1. Press the joystick to display the information.

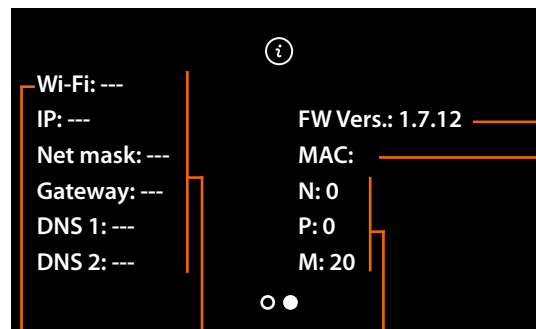

- A Wi-Fi network name to which the Classe100 X16E is connected.
 - B Network parameters.
 - C Firmware version.
 - D MAC address.
 - E Configurator value (see [Configuration](#)).
2. Move the joystick down to select the legal notes.

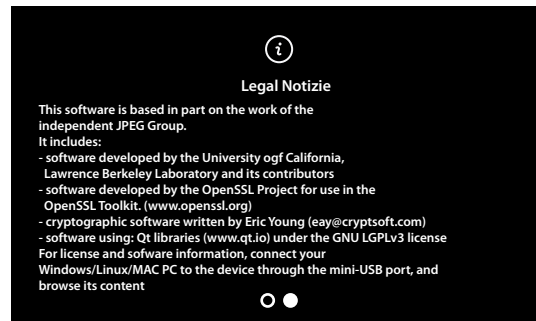

Audio/video parameter adjustments (function not available for the NETATMO cameras)

During a connection to an Internal Unit, Entrance Panel or when using the Call home function with Home + Security app, it is possible to modify the speaker volume and, in case of video connection, the colour, contrast and brightness of the image.



- 1 During a connection press the joystick to modify the parameters



The page shows the type of parameter (A) and the set level (B)

- 2 Move the joystick up/down to select the type of parameter for which you want to modify the value (see the following table)

ICON	TYPE OF PARAMETER
	Speaker volume (Parameter that can be adjusted only with active audio)
	Image brightness
	Image contrast
	Image colour

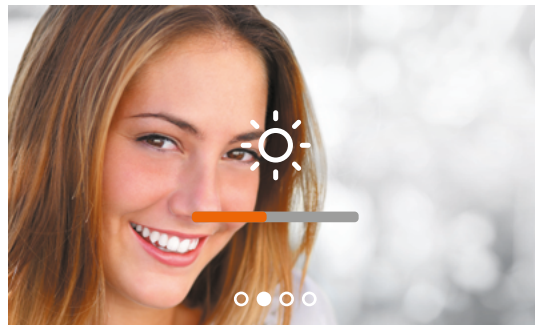

3 Press the joystick to modify the level.



4 Move the joystick up/down to select the desired level.



5 Press the joystick to confirm or wait for the timeout.

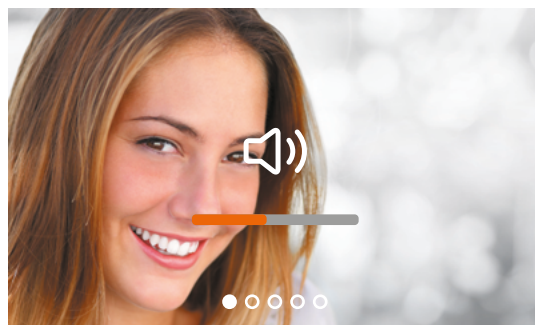

6 Move the joystick up/down to select another parameter or the last page to exit.

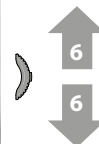

Settings

Settings menu

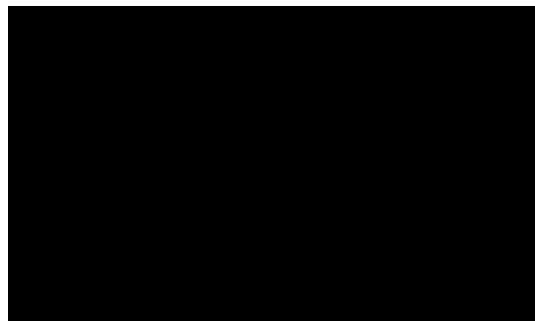

From stand-by, press and hold down the joystick for **about 5 seconds** to activate the display and access the Settings menu

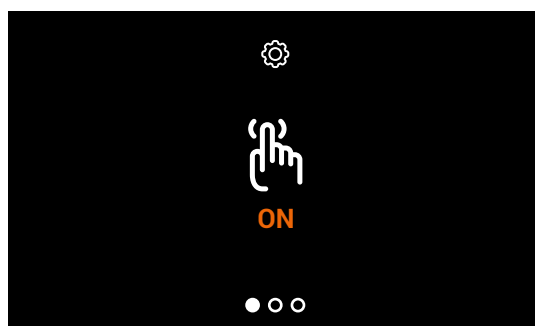

Move the joystick up/down to select the page among:
[Enable/disable the key sound](#)

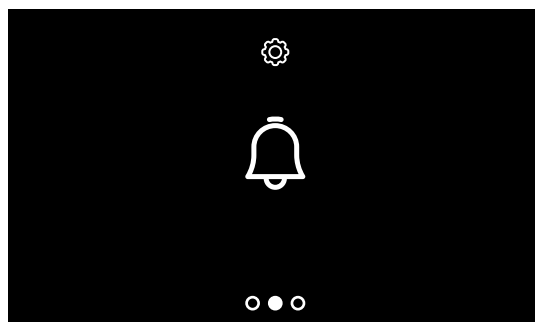

[Associate a ringtone to an event](#)

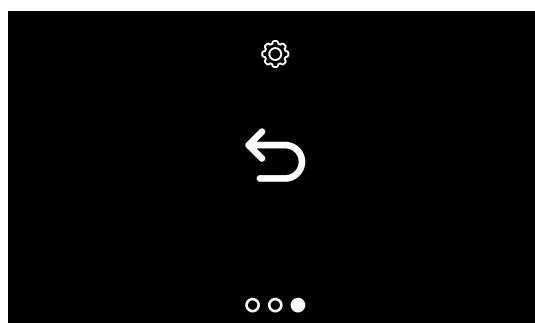

Exit the menu

Enable/disable the key sound

This function enables/disables the BEEP when the keys are pressed. The function is disabled by default, to enable it follow the procedure below:

From stand-by, **press and hold down the joystick for 5 seconds** to access the advanced menu and select the corresponding page.

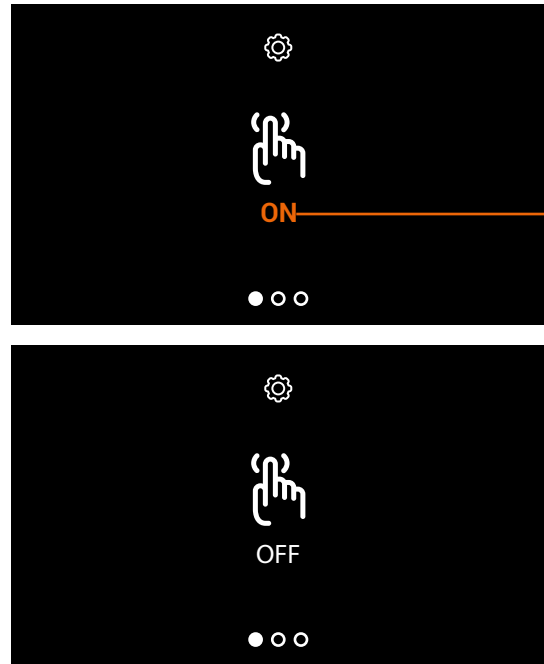

A

1

2

2

1 Function status notification (ON = enabled, OFF = disabled)

1 Press the joystick to change mode.

2 Move the joystick up/down to select another setting or the last page to exit.

Associate a ringtone to an event (call)

This page can be used to modify the ringtones associated to the different types of call. The ringtones played for calls from EP configured with S=2 and S=3 are set by default and cannot be changed (check the Entrance Panel configuration with your installer).

From stand-by **press and hold down the joystick for 5 seconds** to access the advanced menu and select the corresponding page.

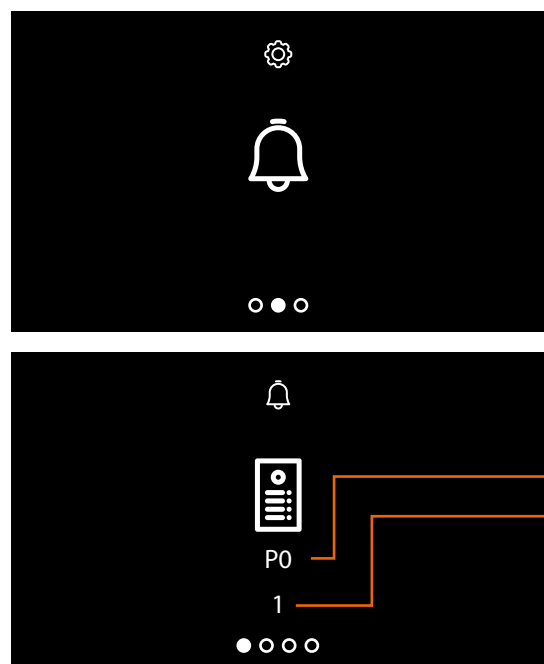

1

2

2

1 Press the joystick to associate the first event.

2 Move the joystick up/down to select the type of call for which you want to set the ringtone (see the following table)

The page shows the type of call (A) and the current ringtone number (B).

ICON	TYPE OF CALL
	Selection of the call ringtone from the MAIN ENTRANCE PANEL
	Selection of the call ringtone from the SECONDARY ENTRANCE PANEL
	FLOOR CALL ringtone selection
	INTERCOM CALL ringtone selection
	EXTERNAL INTERCOM CALL ringtone selection (interface 346850 only)

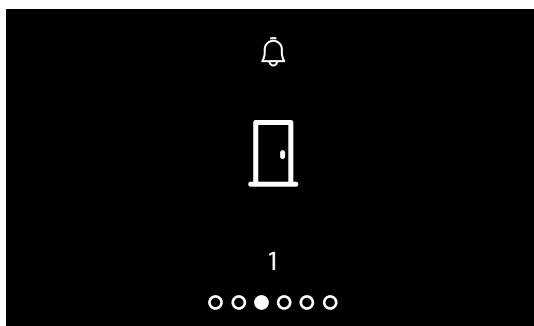

3 Press the joystick to continue

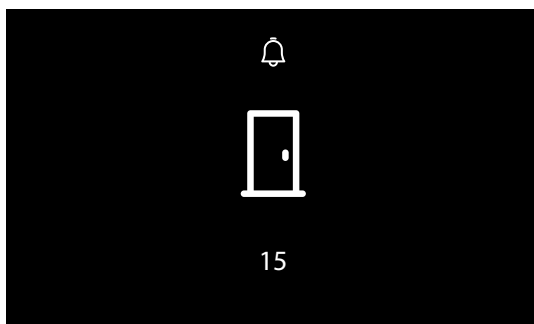

4 Move the joystick up/down to select the ringtone to be associated (the ringtone is played)

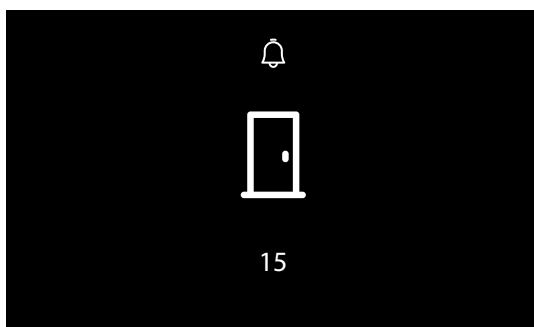

5 Press the joystick to confirm or wait for the timeout

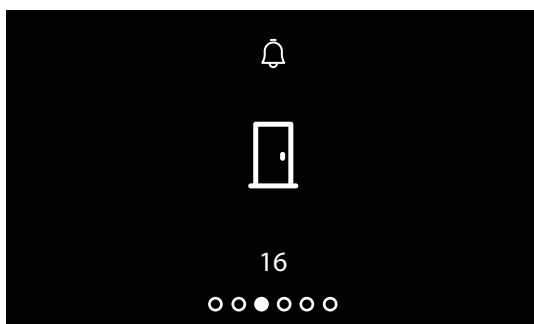

6 Move the joystick up/down to select another call or the last page to exit

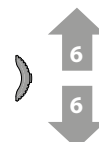

Remote use

Association of Classe100 X16E with Home+Security app

You can interact with your Classe100 X16E with Netatmo using the free Home + Security app. After registering and authenticating, you must make the association with the device; at this point you can:

- answer a video door entry call from the Entrance Panel;
- Call home (call your Classe100 X16E with Netatmo);
- display the images from the entrance panels and cameras;
- open the door lock of the Entrance Panels;



To download the Home + Security app (for iOS devices from App Store, for Android devices from Play Store), scan the QR code with your smartphone



In order to remotely control these functions, first of all download the Home + Security app from the Stores (for iOS® devices from App Store, for Android® devices from Play Store).

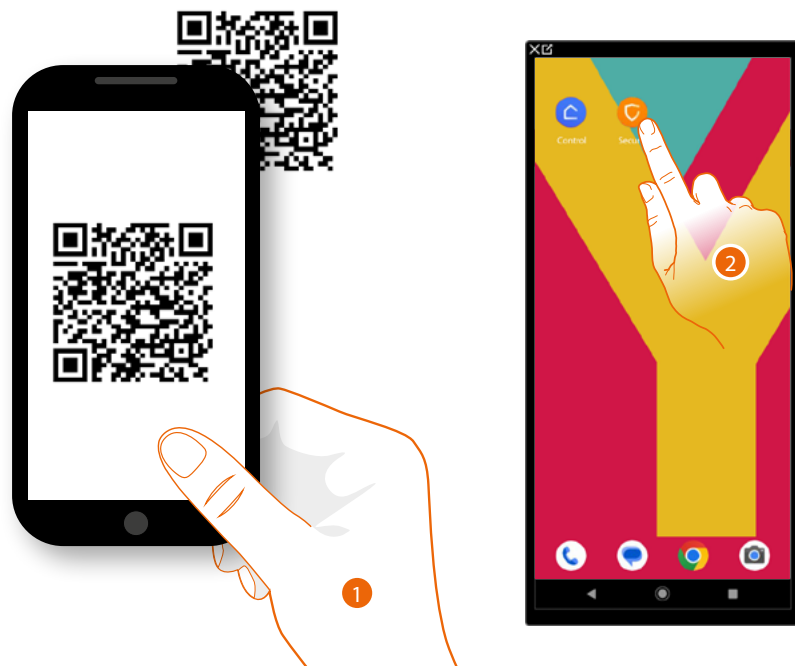

1. On your Smartphone run the App to read the QR codes and then frame the QR Code, or search for the Home + Security App in the stores.
2. After downloading the app, touch to open it.

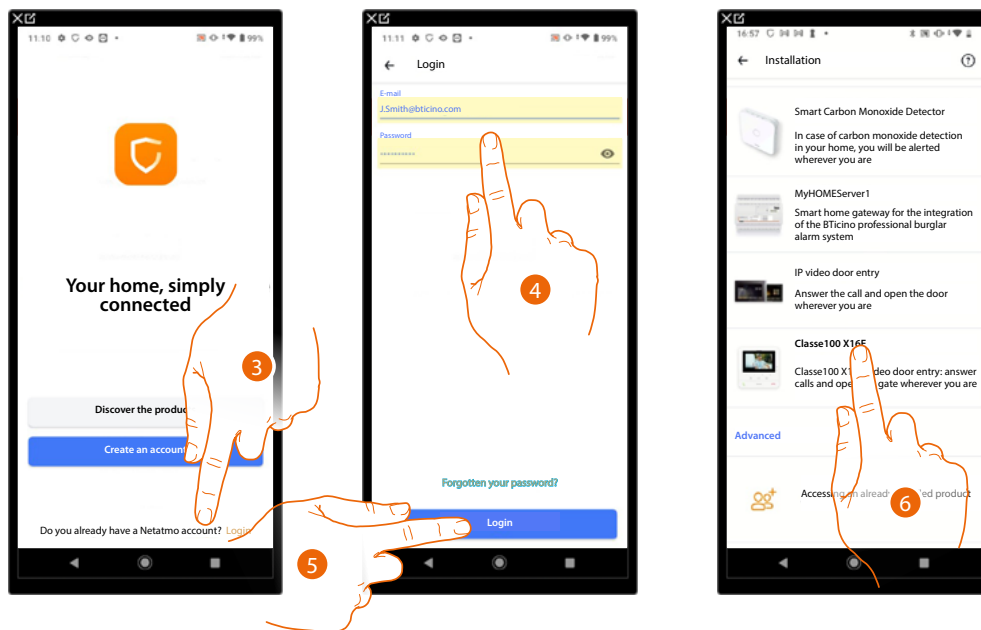

3. Touch to log in to the Home+Security app (after completing the registration process).
4. Enter the login details of the Home+Security app.
5. Touch to continue.

At this point the system will show you a tutorial to help you associate to your device.

Note: before starting the association, make sure that the device is connected to a LAN network connected to the internet.

6. Touch to select the device.

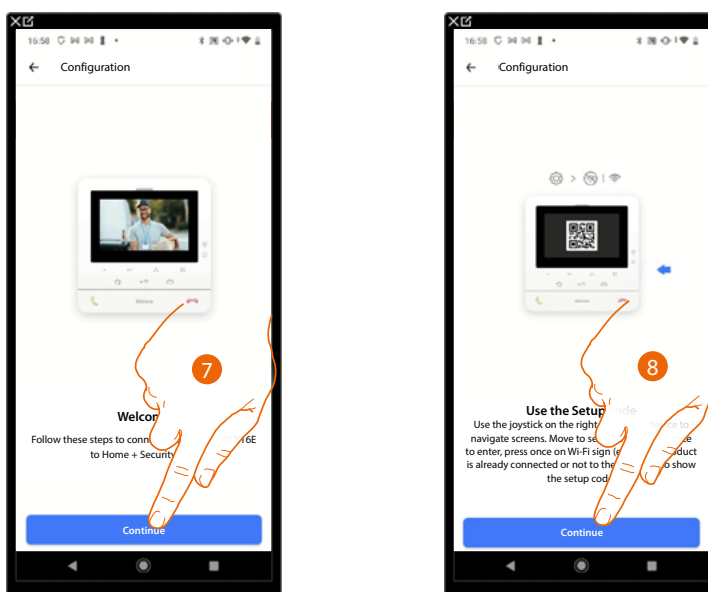

7. Touch to start the association procedure.

Note: if the association procedure is interrupted before it is completed, it is necessary to reset the Classe100 X16E following the procedure

8. Touch to continue and scan the QR code on the device.

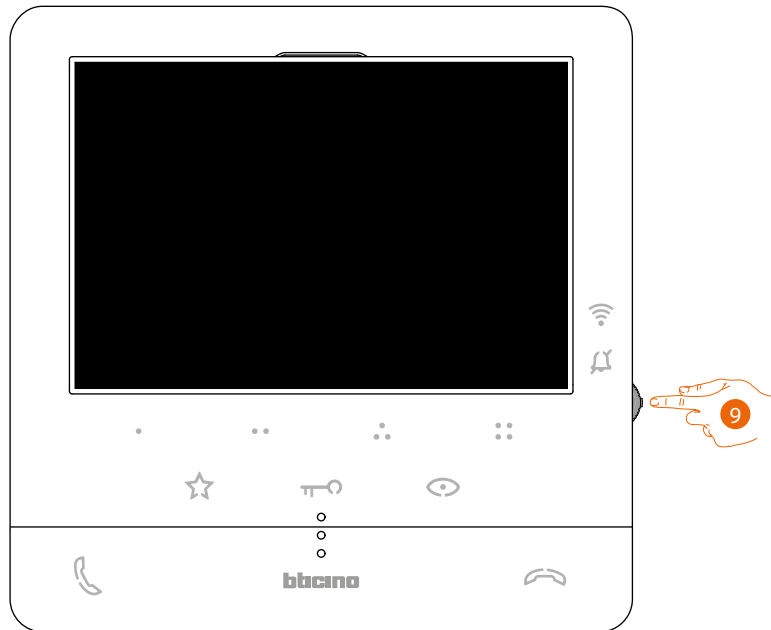

9. From stand-by press the joystick to activate the display.

This screen is displayed to indicate that your Classe100 X16E has never been associated. The screen will disappear once the procedure has been completed successfully.

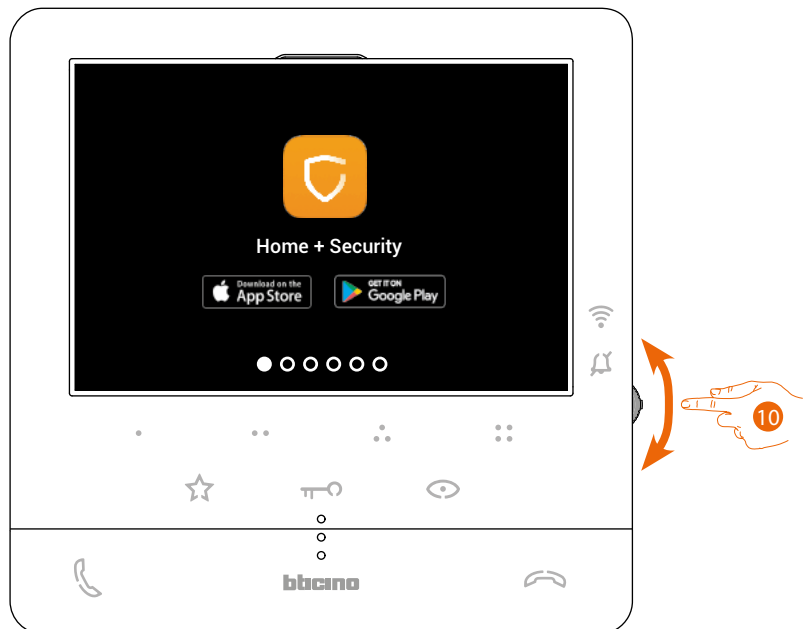

10. Move the joystick down to select the Wi-Fi settings page.

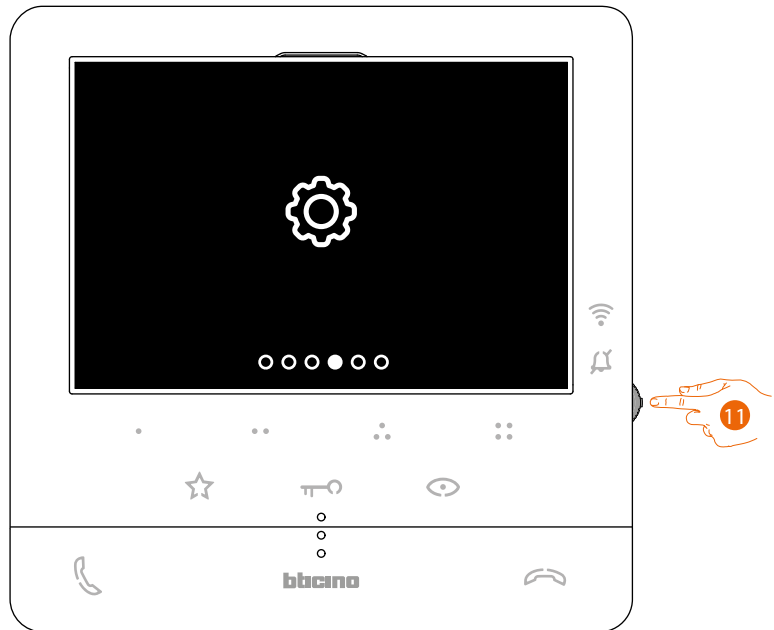

11. Press the joystick to access the page.

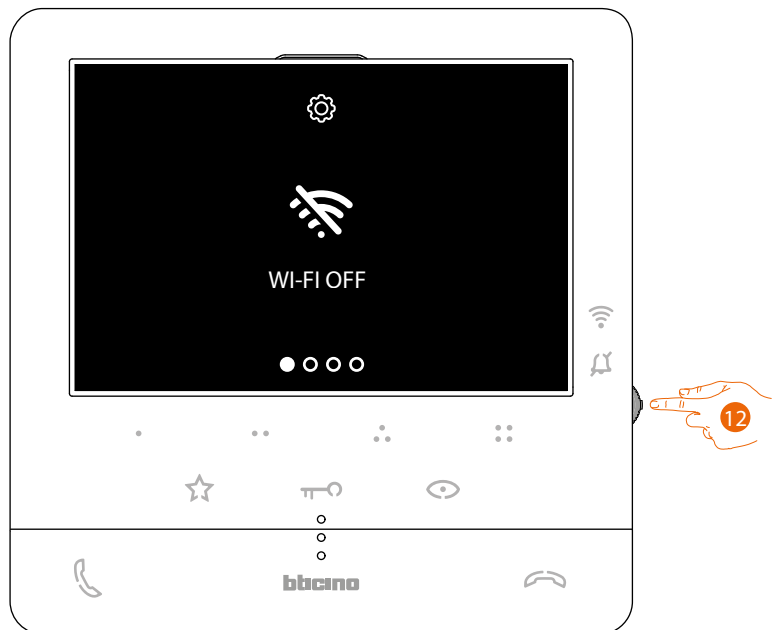

12. Touch to activate the temporary Wi-Fi network created by your Classe100 X16E.

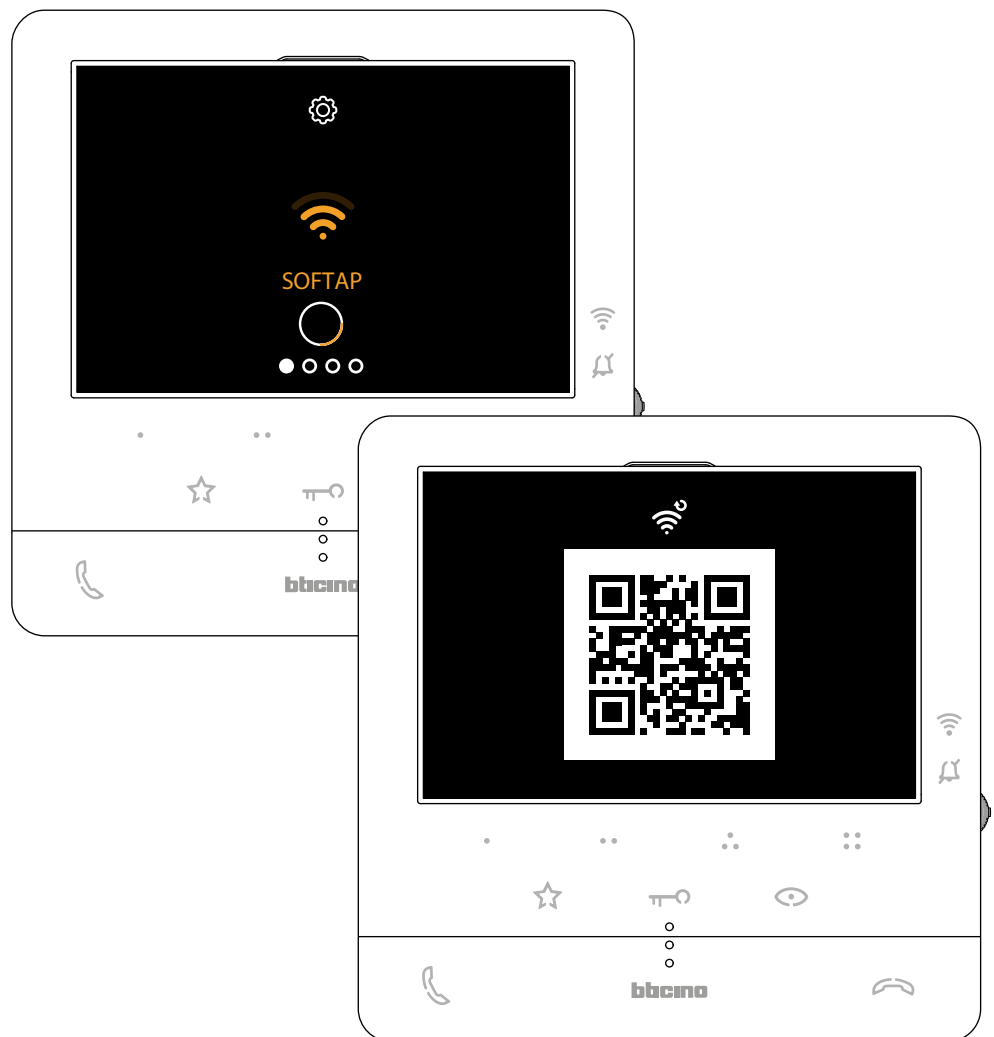

This screen appears, followed by a QR code.



13. Using the smartphone, scan the QR Code.

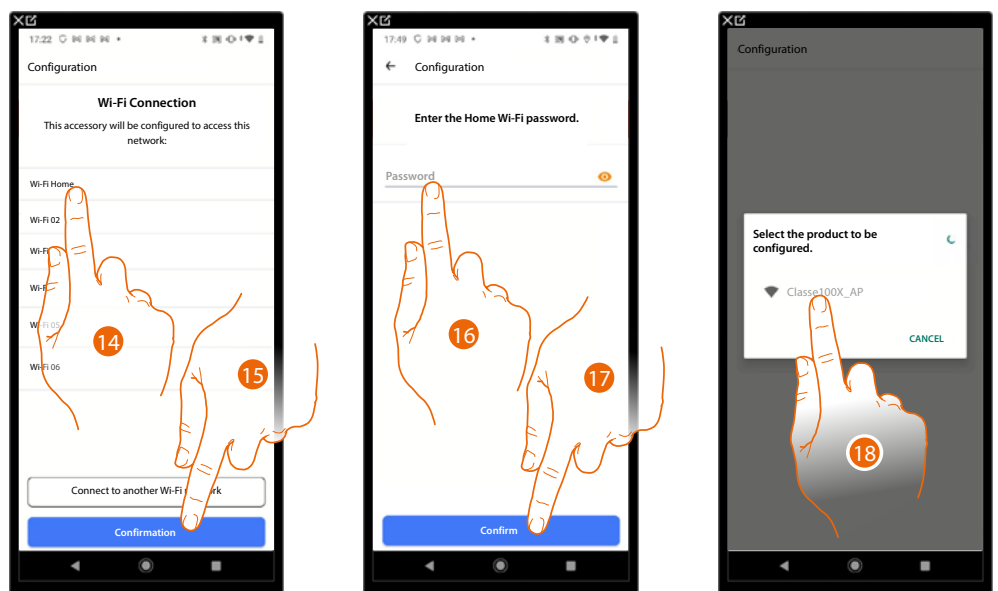

14. Now select the home Wi-Fi network to which the Classe100 X16E will be connected.

15. Touch to confirm.

16. Enter the home Wi-Fi network password.

17. Touch to save it.

18. Select the device to be associated.

Classe100 X16E and the smartphone now start to exchange data. This procedure may take a few minutes.

The completion of the association is confirmed by the confirmation screen.

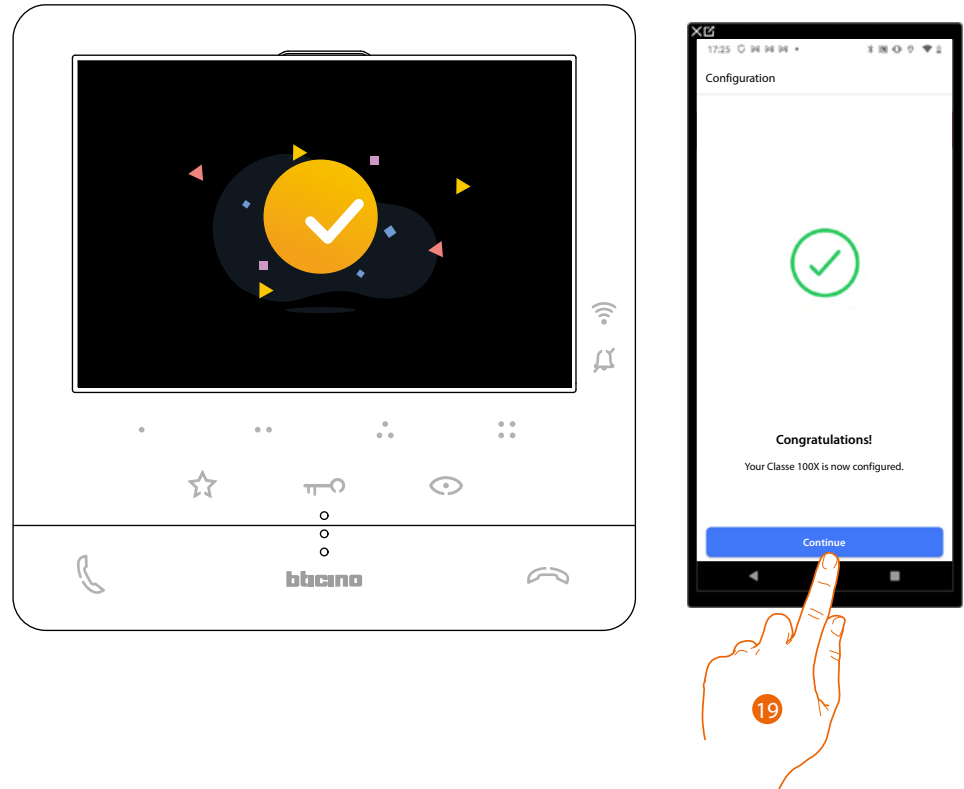

19. Touch to end.

Note: the disconnection of Classe100 X16E from the Wi-Fi network, or the reset of the Wi-Fi network to change the password, are possible using the specific menu **Wi-Fi settings**.

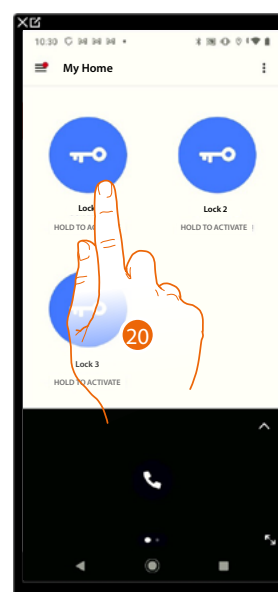

20. Touch to remotely control the device functions.

BTicino SpA
Viale Borri, 231
21100 Varese
www.bticino.com
